



## RESIDENTIAL DOOR HARDWARE ESSENTIALS

Brought to you by Häfele.

# 360° PROJECT SERVICE

## Helping you put the pieces together.

It takes time to complete a new building and carry out the work that is subsequently required. Planning, tendering and order placement, order processing and the post-handover phase each have their own requirements. **Based on specific market demands and with a background of over 90 years experience worldwide, Häfele's 360° Project Service represents a portfolio of services that can meet these needs.**

A comprehensive service on the one hand and an extensive range of Architectural Hardware and Furniture Fittings on the other hand effectively relieves the pressure on Property Developers, Architects, Planners and Processing Companies. The wide range of services means that the customer has a single contact for all phases of the project. This is not just convenient, but also ensures the construction decisions that have been made are consistently implemented and the interests of all parties involved are looked after from the planning phase to the completion of the project.

## Competence in project support and services.

During the course of planning, 360° Project Service provides assistance with the creation of detailed planning manuals, tailored seminars addressing specific topics, tendering texts, application examples, CAD files and other planning and support such as mounting instructions, available at [www.haefe.co.nz](http://www.haefe.co.nz).

However, planning also means: calculating, evaluating and comparing. One of the objectives of project advice is to look for and find the best individual solution for the project. This includes not just in-depth

requirement analysis, but also consistent brand and manufacturer-independent advice. Häfele's enthusiastic and qualified design consultants can assist with integrated and coordinated hardware selection and prepare clear and precise door schedules according to specific project requirements. A central pillar of this service offering is manufacturer independent advice on Architectural and Furniture Hardware. Häfele's specification team are competent, solution oriented partners for architects, builders, investors, specialists, consultants and general contractors. In addition, Häfele also offers extensive support in all phases of the project development. For example, specialized planning aids facilitate the development and implementation of electronic access control systems, lighting concepts in furniture and furnishings, as well as sliding door solutions.

## Order Processing and Handover.

Häfele coordinates and monitors all deadlines and logistical services over the entire construction period. This is made possible because of our individual construction site logistics and just-in-time delivery capability, which Häfele provides with its global sales network and state-of-the-art logistics centres.

Integrated project coordination until handover ensures that the standard of all construction work is consistently high, and guarantees adherence to the defined interests of the Property Developers, Architects and Planners throughout all phases of a project.

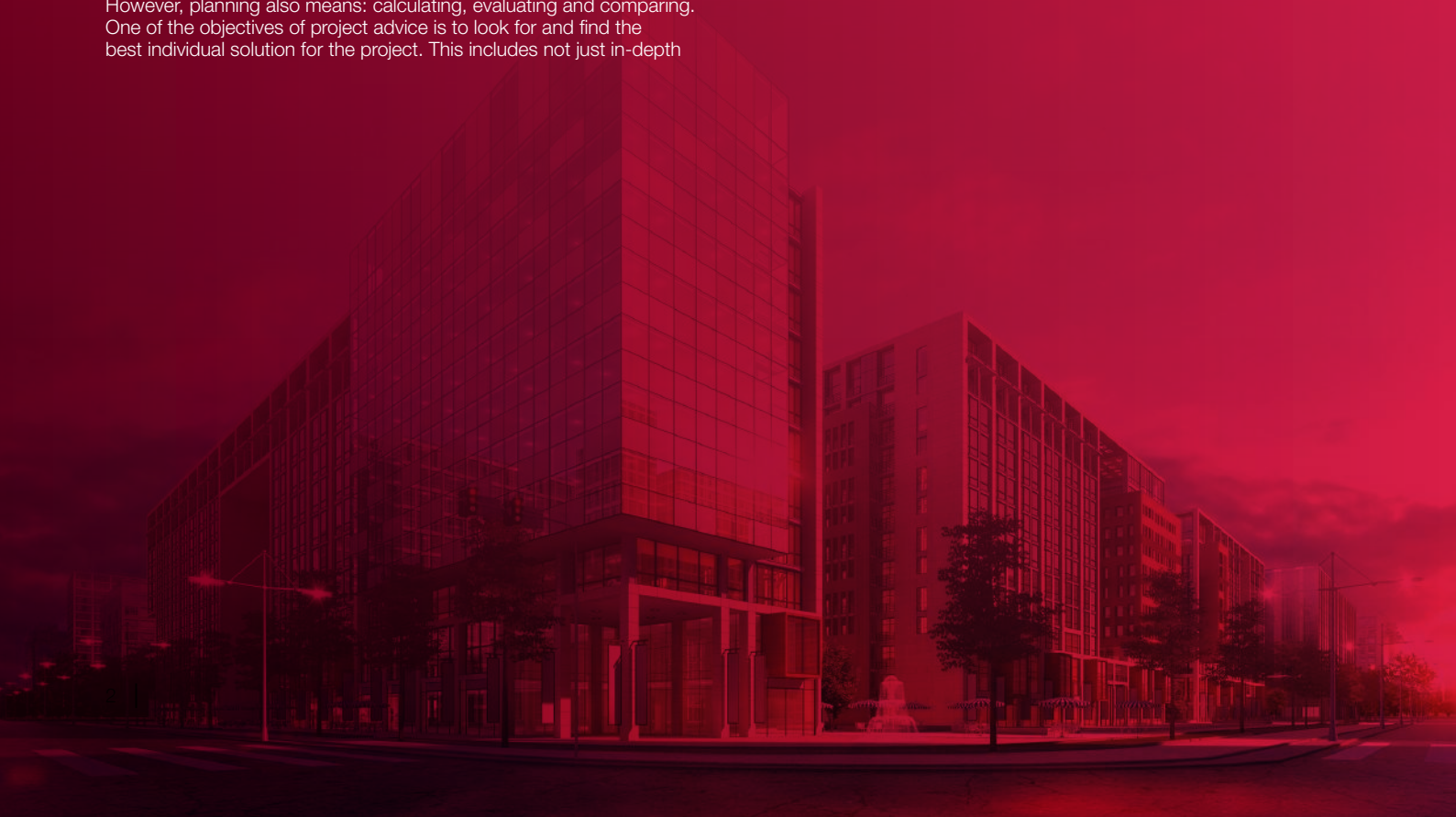





## Lever Handles

StarTec Collection Lever Handles



*Design*

AN INSIGHT INTO  
THE ERGONOMICS  
OF HANDLES

StarTec COLLECTION

# HANDLE ERGONOMICS



## EXTRA VOLUME FOR ERGONOMICS

Door handles that are rounded on all sides are convenient and offer generous grasping volume. Without corners or edges.



## PALM COMFORT

The lever handle is slightly curved upwards and nestles in the hand for ergonomic palm comfort when pressing down.



## STRAIGHT THUMB REST

The part of the lever handle close to the rose supports the thumb when grasping and pressing down.



## ROUNDED THUMB REST

A straight lever handle close with a rounded corner near the rose provides gentle thumb support - whilst lending added stability.



## SECURE GRIP

Lever handles that are rounded in toward the door impart a feeling of security - and provide extra support when pressing down preventing slippage.



## THE FIRST TOUCH.

Every time we enter a new space, it all begins with a first touch: the door handle. When we take hold of it, new spaces, expanses and whole new worlds open up to us. The door handle as a connecting element between people and spaces. Functional, elegant and eminently graspable.

**This brochure showcases a selection from our product range.**

# HOW TO SPECIFY THE HANDLES IN A HOME?

1.

## **Choose the handle you prefer.**

Consider whether a curved, bold or ergonomic handle is required.

All handles come in a versatile stainless, matt finish to compliment any enviroment.



2.

## **Choose the latching options, locking and privacy.**

Consider how important the security aspect of the door is.  
How much traffic will be entering through the door.



3.

## **Choose door stop and accessories.**



DID YOU KNOW HÄFELE CAN PUT TOGETHER  
A DOOR HARDWARE SCHEDULE FOR YOU?





*Lyra*

The **LYRA** lever handle as rosette and escutcheon set with WC aperture.

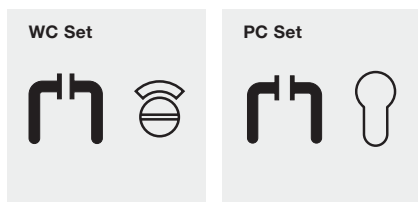

*StarTec*

Version	Door thickness (mm)	Cat. No.
PC Set	38 - 42	903.82.110
WC Set	38 - 42	903.83.110



**Supplied with:**

- > 2 Lever Handle Aperture Parts
- > 1 Spindle (8x100mm)
- > 1 Pair Handle Roses
- > 1 Pair Escutcheons with Indicator Disc (WC Set)
- > 1 Locking Pin (8x62mm)
- > 4 Chipboard Screws (4x50mm)
- > 8 Chipboard Screws (3.9x19mm)
- > 1 Pair of Euro Cylinder Escutcheons (PC Set)



*Scorpius*

The **SCORPIUS** lever handle as rosette and escutcheon set with WC aperture.

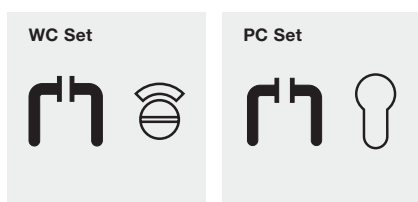

*StarTec*

Version	Door thickness (mm)	Cat. No.
PC Set	38 - 42	903.92.890
WC Set	38 - 42	903.93.890



**Supplied with:**

- > 2 Lever Handle Aperture Parts
- > 1 Spindle (8x100mm)
- > 1 Pair Handle Roses
- > 1 Pair Escutcheons with Indicator Disc (WC Set)
- > 1 Locking Pin (8x62mm)
- > 4 Chipboard Screws (4x50mm)
- > 8 Chipboard Screws (3.9x19mm)
- > 1 Pair of Euro Cylinder Escutcheons (PC Set)





*Orion*

The **ORION** lever handle as rosette and escutcheon set with WC aperture.

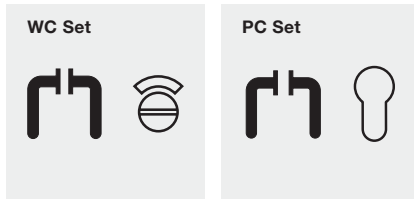

Version	Door thickness (mm)	Cat. No.
PC Set	37 - 46	902.92.884
WC Set	37 - 46	902.93.884



**Supplied with:**

- > 2 Lever Handle Aperture Parts
- > 1 Spindle (8x100mm)
- > 1 Pair Handle Roses
- > 1 Pair Escutcheons with Indicator Disc (WC Set)
- > 1 Locking Pin (8x62mm)
- > 4 Chipboard Screws (4x50mm)
- > 8 Chipboard Screws (3.9x19mm)
- > 1 Pair of Euro Cylinder Escutcheons (PC Set)

*StarTec*



*Aries*

The **ARIES** lever handle as rosette and escutcheon set with WC aperture.

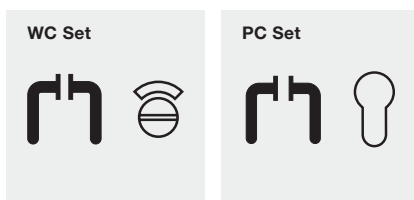

Version	Door thickness (mm)	Cat. No.
PC Set	38 - 42	903.82.130
WC Set	38 - 42	903.83.130



**Supplied with:**

- > 2 Lever Handle Aperture Parts
- > 1 Spindle (8x100mm)
- > 1 Pair Handle Roses
- > 1 Pair Escutcheons with Indicator Disc (WC Set)
- > 1 Locking Pin (8x62mm)
- > 4 Chipboard Screws (4x50mm)
- > 8 Chipboard Screws (3.9x19mm)
- > 1 Pair of Euro Cylinder Escutcheons (PC Set)

*StarTec*



# Carina

The **CARINA** lever handle as rosette and escutcheon set with WC aperture.

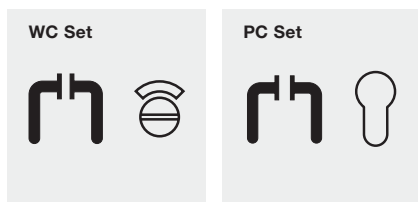

StarTec

Version	Door thickness (mm)	Cat. No.
PC Set	38 - 55	903.92.666
WC Set	38 - 45	903.93.666



#### Supplied with:

- > 2 Lever Handle Aperture Parts
- > 1 Spindle (8x100mm)
- > 1 Pair Handle Roses
- > 1 Pair Escutcheons with Indicator Disc (WC Set)
- > 1 Locking Pin (8x62mm)
- > 4 Chipboard Screws (4x50mm)
- > 8 Chipboard Screws (3.9x19mm)
- > 1 Pair of Euro Cylinder Escutcheons (PC Set)



# Hercules

The **HERCULES** lever handle as rosette and escutcheon set with WC aperture.

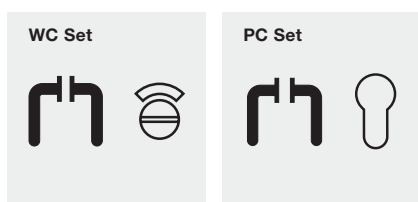

StarTec

Version	Door thickness (mm)	Cat. No.
PC Set	38 - 42	903.82.070
WC Set	38 - 42	903.83.070



#### Supplied with:

- > 2 Lever Handle Aperture Parts
- > 1 Spindle (8x100mm)
- > 1 Pair Handle Roses
- > 1 Pair Escutcheons with Indicator Disc (WC Set)
- > 1 Locking Pin (8x62mm)
- > 4 Chipboard Screws (4x50mm)
- > 8 Chipboard Screws (3.9x19mm)
- > 1 Pair of Euro Cylinder Escutcheons (PC Set)



## Door Locks and Security

Tubular Latches | Mortise Locks | Cavity Door Locks

## DIGITAL DOOR LOCK EL8000



- > Dimensions: Front module: 76 (W) x 306 (H) x 28 (D)  
Back module: 71 (W) x 298 (H) x 30.7 (D)
- > Features:
  - Volume control function
  - Easy to program and reprogram up to 8 combination codes
  - Security coding function
  - Panic release handle
  - Non handed
  - Auto locking/auto relocking function
  - Auto/manual locking mode
  - Register up to 20 key cards
  - Intrusion and tamper warning function
  - Low battery warning function
  - Power saving mode
  - Double locking function
  - For door thickness 40-50 mm

Digital Door Lock, EL8000

Description	Cat. No.
EL8000	912.05.359
Packing: 1 set	

**Supplied with:**

- > 1 Front and Rear Module
- > 1 Mortise Lock and Striking Plate
- > 1 Set of Fixing Material
- > 1 User Manual
- > 1 Installation Template
- > 8 Batteries
- > 3 Mechanical Keys
- > 2 Cards
- > 2 Tags

## DIGITAL DOOR LOCK ER4800



- > Dimensions: Front module: 71.8 (W) x 163.6 (H) x 18.4 (D)  
Back module: 154 (W) x 93 (H) x 37 (D)
- > Features:
  - Smart card 50 max. Combination code 10 max.
  - Combination code and smart card
  - One off code function
  - Security coding function
  - Auto locking function
  - Easily retrofit-able
  - Strike comes complete with packers, in-line and offset installation possible
  - Mifare card technology
  - One touch (lock/unlock button)
  - Low battery warning function
  - Intrusion warning function
  - Tamper warning function
  - Double locking function
  - For door thickness 40-50 mm

Digital Door Lock, ER4800

Description	Cat. No.
ER4800	912.05.361
Packing: 1 set	

**Supplied with:**

- > 1 Front and Rear Module
- > 1 Striking Plate
- > 1 Set of Fixing Material
- > 1 User Manual
- > 1 Installation Template
- > 4 Batteries
- > 4 Cards



## TUBULAR LATCH, DUAL SPRUNG 8 MM HUB BACKSET 60MM



Tubular Latch, Dual Sprung, Backset 60 mm

Material	Finish	Spindle	Cat. No.
Stainless steel	Satin	8 mm	911.03.090

Packing: 1 piece



### Supplied with:

- > 1 Strike Plate
- > Fixing material

## TUBULAR BOLT, WITH 8 MM HUB BACKSET 60MM



Tubular Bolt, Backset 60 mm

Material	Finish	Spindle	Cat. No.
Stainless steel	Satin	8 mm	911.22.406

Packing: 1 piece



### Supplied with:

- > 1 Strike Plate
- > Fixing material

## MORTISE LATCH LOCK BACKSET 55MM

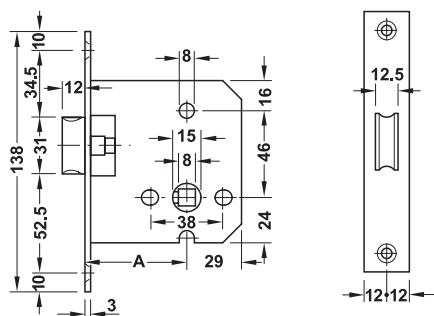

- > Version: For flush doors
- > Material: Forend and latch bolt: Stainless steel, Lock case: Steel
- > Lever follower: 8 mm
- > Mounting: DIN left/DIN right, reversible

Mortise Latch Lock, Backset 55 mm

Forend width	Forend	Cat. No.
24 mm	Square	911.23.370

Packing: 1 piece

**Supplied with:**

- > 1 Mortise Latch Lock
- > 1 Flanged Strike Plate
- > 1 Deadbolt Pocket

## MORTISE LOCK PROFILE CYLINDER BACKSET 55MM

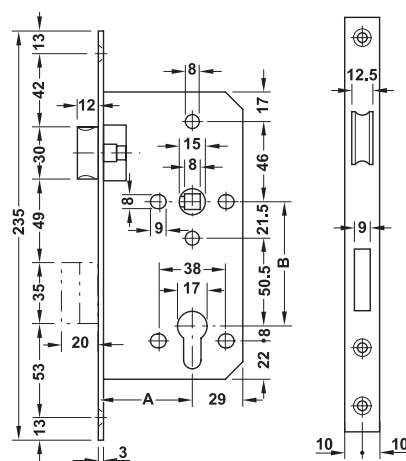

- > Version: For rebated or flush doors. With key action.
- > Material: Forend, latch bolt and deadbolt: Stainless steel, Lock case: Steel
- > Deadbolt: 2 turn
- > Lever follower: 8 mm
- > Mounting: DIN left/DIN right, reversible

Mortise Lock Profile Cylinder, Backset 55 mm

Forend width	Forend	Cat. No.
24 mm	Square	911.02.145

Packing: 1 piece

**Supplied with:**

- > 1 Mortise Lock
- > 1 Flanged Strike Plate
- > 2 Deadbolt Pockets

**Note:**

- > Suitable for Euro Cylinder

### MORTISE LOCK, BATHROOM WC BACKSET 55MM

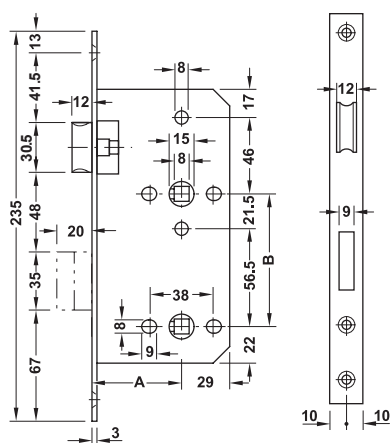

- > Version: For rebated or flush doors
- > Material: Forend, latch bolt and deadbolt: Stainless steel, Lock case: Steel
- > Lever follower: 8 mm
- > Mounting: DIN left/DIN right, reversible
- > Deadbolt: 1 turn

#### Mortise Latch Lock, Backset 55 mm

Forend width	Forend	Cat. No.
24 mm	Square	911.02.149

Packing: 1 piece



#### Supplied with:

- > 1 Mortise Lock
- > 1 Flanged Strike Plate
- > 2 Deadbolt Pockets

### MORTISE DEADLOCK PROFILE CYLINDER BACKSET 55MM

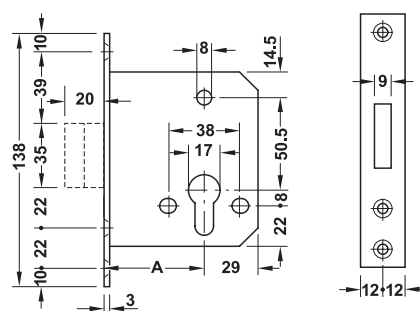

- > Version: For flush doors.
- > Material: Forend, and deadbolt: Stainless steel, Lock case: Steel
- > Closure: Prepared for profile cylinder
- > Deadbolt: 2 turn
- > Lever follower: 8 mm
- > Mounting: DIN left/DIN right, reversible

#### Mortise Deadlock Profile Cylinder, Backset 55 mm

Forend width	Forend	Cat. No.
24 mm	Square	911.22.490

Packing: 1 piece



#### Supplied with:

- > 1 Mortise Deadlock
- > 1 Flanged Strike Plate
- > 1 Deadbolt Pocket



#### Note:

- > Suitable for Euro Cylinder

## SLIDING CAVITY DOOR LOCK FOR TIMBER DOORS

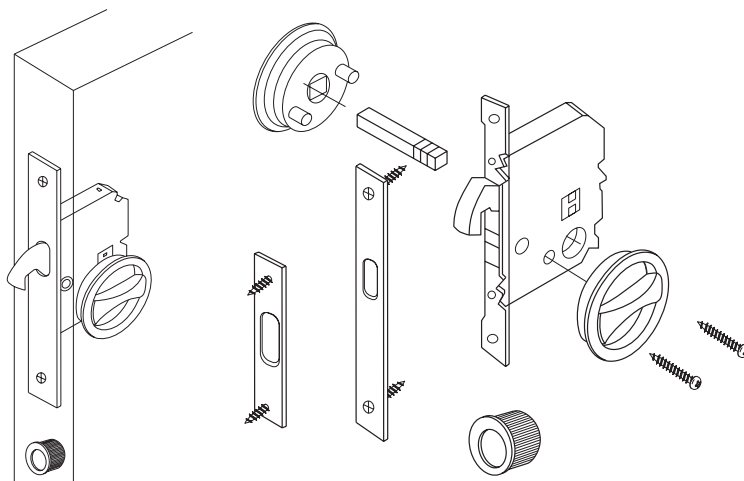

- > Version: For timber sliding cavity doors, suits 54 mm hole
- > Function: Privacy or passage
- > Material: Stainless steel
- > Finish: Satin

### Sliding Cavity Door Lock

Design	Version	Finish	Cat. No.
Round	Privacy	Satin	911.26.484
		Matt Black	911.26.494
	Passage	Satin	911.26.486
		Matt Black	911.26.496
Square	Privacy	Satin	911.26.480
		Matt Black	911.26.490
	Passage	Satin	911.26.482
		Matt Black	911.26.492

Packing: 1 set





- > Version: For flush doors
- > Lever follower: 8 mm
- > Mounting: Left hand or right hand, reversible

Tubular Magnetic Latch, 8 mm Spindle, 60 mm Backset

Material	Finish	Spindle	Cat. No.
Stainless steel	Satin	8	911.22.840

Matching Tubular Bolt for Privacy WC

Material	Cat. No.
Stainless steel	911.22.841

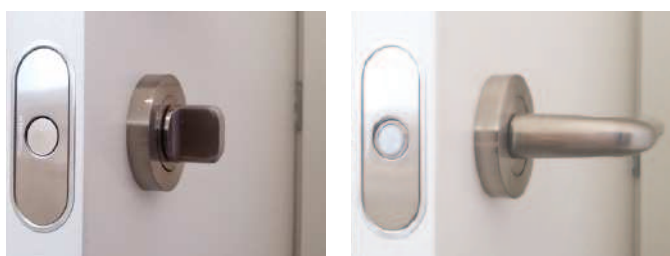

### Supplied with:

- > 1 Strike plate
- > Fixings



- > Area of application: Ideal for wardrobe doors and cupboards

Door Magnetic Catch

Material	Finish	Cat. No.
Stainless steel	Satin	489.70.120



### Supplied with:

- > Fixings

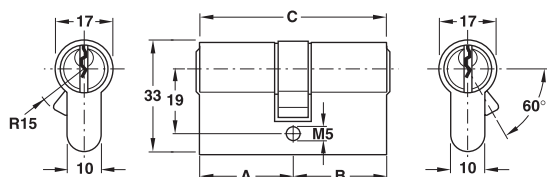

Length A	35 mm
Length B	35 mm
Length C	70 mm

- > Features: With 6 pin tumblers
- > Key profile: C4
- > Material: Brass
- > Finish: Satin chrome

## Double Euro Profile Cylinder C4

Version	Key Change	Cat. No.
Keyed to differ	-	916.84.100
Keyed alike	1	916.84.101
	2	916.84.102
	3	916.84.103
	4	916.84.104
	5	916.84.105
	6	916.84.106

Packing: 1 piece

**Supplied with:**

- > 1 Profile Double Cylinder
- > 3 Steel Keys, Nickel Plated
- > 1 Cylinder Retaining Screw

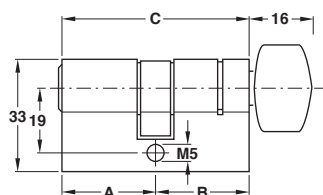

Length A	35 mm
Length B	35 mm
Length C	70 mm

- > Features: With 6 pin tumblers
- > Key profile: C4
- > Material: Brass
- > Finish: Satin chrome

## Euro Profile Thumbturn Cylinder C4

Version	Key Change	Cat. No.
Keyed to differ	-	916.84.200
Keyed alike	1	916.84.201
	2	916.84.202
	3	916.84.203
	4	916.84.204
	5	916.84.205
	6	916.84.206

Packing: 1 piece

**Supplied with:**

- > 1 Profile Double Cylinder
- > 3 Steel Keys, Nickel Plated
- > 1 Cylinder Retaining Screw

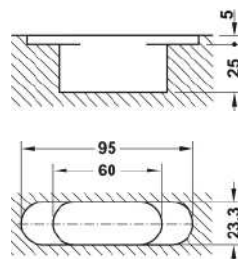
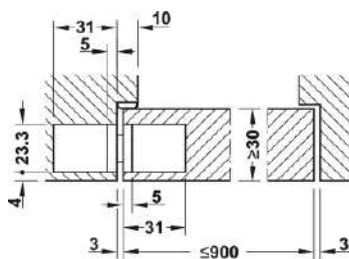
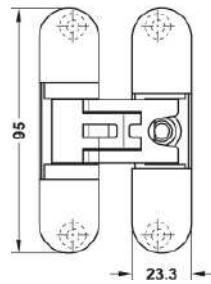

- > Area of application: For wooden frames, for flush wooden interior doors
- > Door weight (kg): ≤45 with 2 door hinges, ≤60 with 3 door hinges
- > Opening angle: ≤180°
- > Door width (mm): ≤900
- > Door height (mm): ≤2000
- > Door thickness (mm): ≥32
- > Size (mm): 95
- > Adjustment facility: Continuously 3D adjustable: Height: ±2.5 mm, side: +3/-2 mm and closing pressure: ±1 mm
- > Allen key for adjustment supplied

### Concealed Mortise Hinge H2, Size 95 mm

Material	Finish	Cat. No.
Zinc alloy	Chrome plated matt	927.91.544

Packing: 1 piece



#### Note:

- > Different recess dimensions when using hinge pockets for lining frames.
- > 4 door hinges must be used for door height of 2,100 mm and above

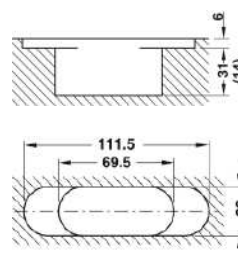
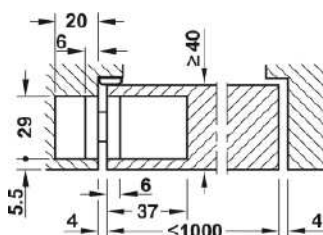
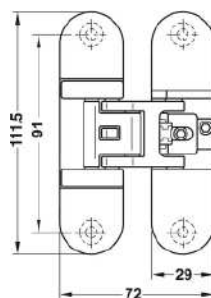

- > Area of application: For wooden frames, for flush wooden interior doors
- > Door weight (kg): ≤50 with 2 door hinges, ≤70 with 3 door hinges
- > Opening angle: ≤180°
- > Door width (mm): ≤1000
- > Door height (mm): ≤2100
- > Door thickness (mm): ≥40
- > Size (mm): 111.5
- > Adjustment facility: Continuously 3D adjustable: Height: ±3 mm, side: +3/-2 mm and closing pressure: ±1 mm

### Concealed Mortise Hinge H7, Size 111.5 mm

Material	Finish	Cat. No.
Zinc alloy	Chrome plated matt	927.91.554

Packing: 1 piece



#### Note:

- > Different recess dimensions when using hinge pockets for lining frames.
- > 4 door hinges must be used for door height of 2,400 mm and above

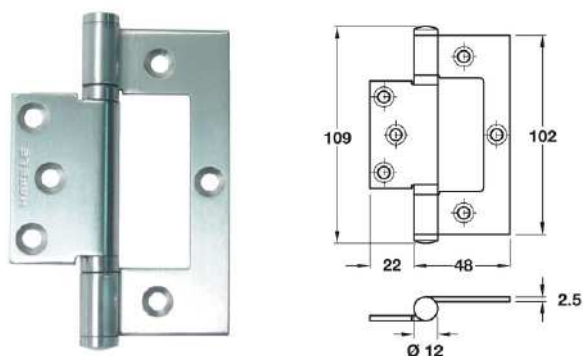

- > Features: For timber or aluminium frames  
Quick mounting  
Knuckle with 2 ball bearings  
Offset leaf  
2 Screw lengths to suit timber or aluminium
- > Handing: Non-handed
- > Max. door weight: 45 kg
- > Knuckle diameter: 12 mm
- > Material thickness: 2.5 mm

## Fastfix Hinge

Material	Finish	Cat. No.
Stainless steel (304)	Satin	926.97.001
Packing: 2 pieces		



## Supplied with:

- > 10 and 25 mm Stainless steel undercut screws for aluminium or timber

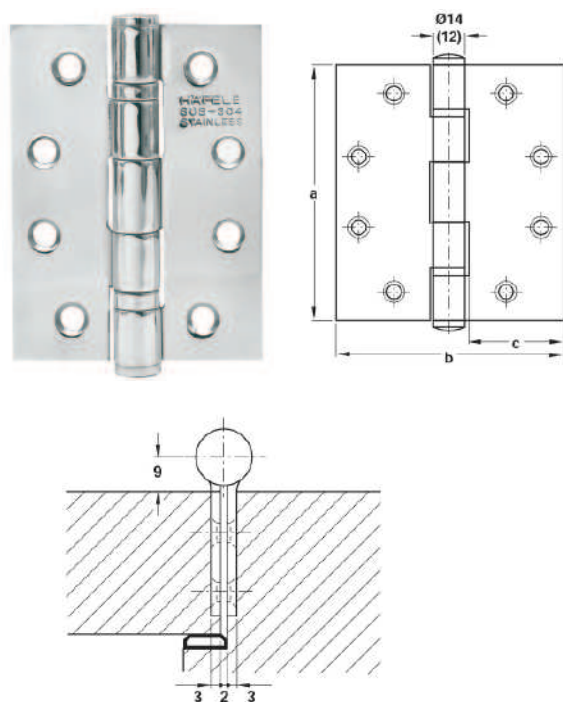

- > Features: For timber or steel frames  
Knuckle with 2 ball bearings  
Standard metric template pattern  
Fixed pin
- > Max. door weight: 80 kg
- > No. of hinges: 2 for doors up to 50 kg  
3 for doors 51 - 80 kg
- > Knuckle diameter: 14 mm
- > Material thickness: 3 mm
- > Fixing: Cutting depth 3.15 mm

## Butt Hinges, Ball Bearing

Material	Finish	Cat. No.
Stainless steel (304)	Satin	926.84.030
Packing: 2 pieces		



## Supplied with:

- > 8 Wood and 4 metal thread screws per hinge

## 100 x 75 mm hinges

Height A	100 mm
Height B	75 mm
Leaf width C	30 mm



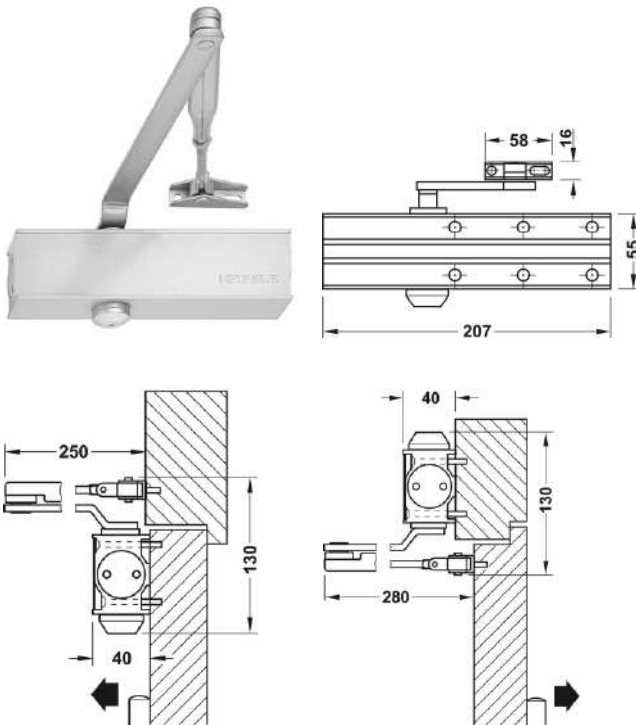

- > Version: With standard arm or interlocking hold-open arm (optional)
- > Installation: Suitable for standard installation on pull side and overhead installation on pull side
- > Adjustment facility: Closing speed, backcheck and latching action adjustable
- > Door width:  $\leq 1100$  mm
- > Opening angle:  $\leq 180^\circ$
- > Hold-open angle:  $\leq 145^\circ$
- > Mounting: For DIN left and DIN right hand use

### Overhead Door Closers

Silver colour lacquered	Cat. No.
1 DCL 15 with standard arm	931.84.629
1 DCL 16 with hold-open arm	931.84.639

Packing: 2 pieces



#### Supplied with:

- > Door closer complete with arm assembly

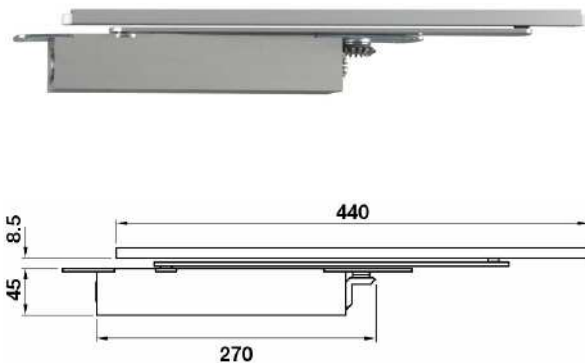

- > Area of application: Door closer and guide rail for concealed installation in door
- > Version: With mechanical, electromechanical or without hold open function
- > Adjustment facility: Closing force and closing speed continuously adjustable, latching action hydraulically adjustable, hydraulic back check adjustable
- > Door thickness:  $> 40$  mm
- > Door width:  $\leq 1100$  mm
- > Max door weight: 130 kg
- > Opening angle:  $\leq 120^\circ$
- > Hold-open angle: 80 - 120°
- > Mounting: For DIN left hand and DIN right hand use

### Boxer I Door Closers

Silver colour	Cat. No.
Boxer I set with guide rail and hold open insert	931.15.009

Packing: 1 piece



#### Supplied with:

- > Door closer complete with hold open insert

Flush door without hold open function

Flush door with mechanical hold open function



Wall Mounted Door Stop

Material	Finish	Dim A mm	Cat. No.
Stainless steel	Satin	48	937.12.120
		60	937.12.110
		78	937.12.100

Packing: 1 piece

**Supplied with:**

&gt; Fixing material

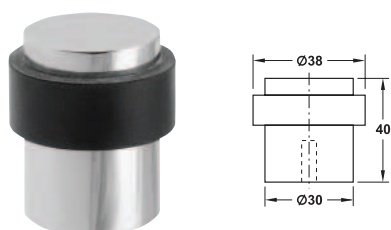

Floor Mounted Door Stop

Material	Finish	Cat. No.
Stainless steel	Matt	937.52.080

Packing: 1 piece

**Supplied with:**

&gt; Fixing material

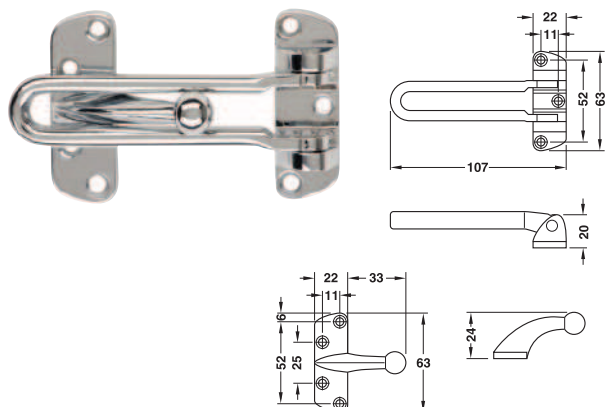

Door Guard

Material	Finish	Cat. No.
Zinc alloy	Chrome plated	911.59.187

Packing: 1 piece

**Supplied with:**

&gt; Fixing material

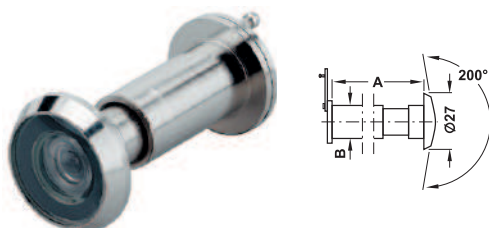

Door Viewer

Material	Finish	Cat. No.
Brass	Chrome plated	959.00.003

Packing: 1 piece

**Supplied with:**

&gt; Fixing material

- > Dimension A= 35.55 mm
- > Dimension B= Ø14 mm



## Door Seals

Drop Seals | Batwing Seals

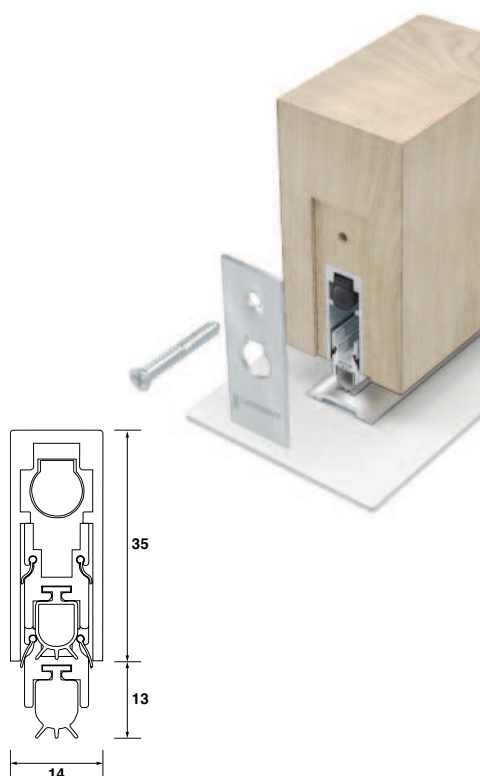

- > **Features:** Fully concealed in bottom of door  
Dual internal sealing fins enhance acoustic and smoke containment performance.  
Supplied with high performance fire rated silicone rubber gasket.  
Fully automatic, no power connection required.  
Simple adjustment to suit varying door gap requirements.  
Proven long term reliability.
- > **Fixing:** Fits into a 15 mm wide x 35 mm deep groove and retained in place with screw fixed stainless steel end plates.
- > **Gap sizes (mm):** Accommodates and seals gaps up to 13 mm.  
Greater gaps can be sealed if used with a threshold plate.
- > **Finish:** Silver anodised aluminium with stainless steel end plates and grey silicone rubber gasket.

Drop Seal (LAS8001si) **Medium Duty**

Length mm	Cat. No.
435	950.11.295
535	950.11.229
635	950.11.194
820	950.11.195
920	950.11.196
1070	950.11.197
1220	950.11.230
1400	950.11.231
1600	950.11.296

Packing: 1 piece

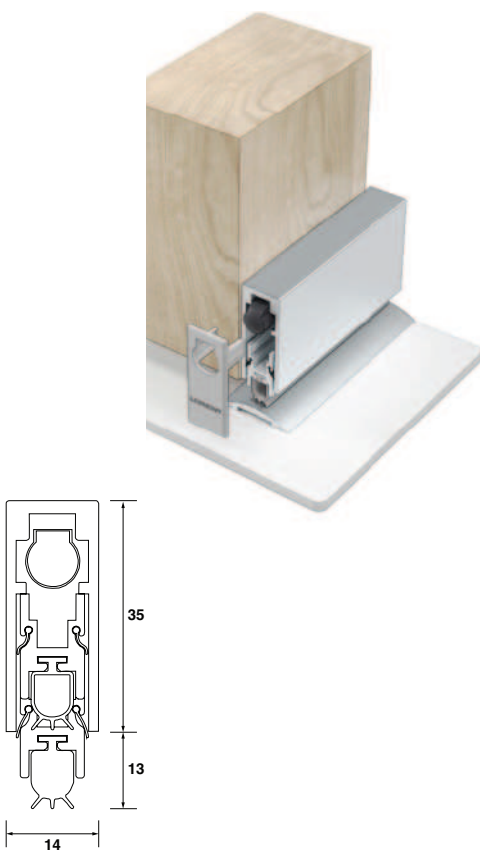

- > **Features:** Effective acoustic and smoke sealing solution that can easily be retrofitted to existing door assemblies.  
Dual internal sealing fins enhance acoustic and smoke containment performance.  
Quickly and easily fitted to the bottom of door.  
Can be fitted semi-morticed for a flush finish.  
Supplied with a fire rated silicone rubber gasket and aesthetic push-fit end caps.  
Fully automatic, no power connection required.  
Simple adjustment to suit varying door gap requirements.  
Proven long term reliability.
- > **Fixing:** Face-fixed or semi-morticed to the bottom of the door.  
Fixing screws are supplied.
- > **Gap sizes (mm):** Accommodates and seals gaps from 1 to 13 mm.  
Greater gaps can be sealed if used with a threshold plate.
- > **Finish:** Silver anodised aluminium with grey push-fit end caps and grey silicone rubber gasket

Drop Seal (LAS8002si) **Medium Duty**

Length mm	Cat. No.
435	950.11.297
535	950.11.232
635	950.11.233
820	950.11.234
920	950.11.198
1070	950.11.235
1220	950.11.236
1400	950.11.237
1600	950.11.298

Packing: 1 piece



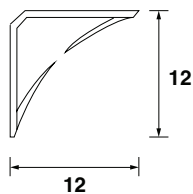

- > Fixing: Aggressive film backed self-adhesive.
- > Gap sizes (mm): LAS1212 - 2-3 mm
- > Finish: Standard colour: Black with black fins.  
White, grey, brown and clear available to special order.  
(note clear does not restrict light penetration).

### Batwing Seal (LAS1212) Medium Duty

Length mm	Cat. No.
1000	950.11.207
2100	950.11.208
2750	950.11.209
Single door set	950.11.210
Long single door set	950.11.199
Double door set	950.11.211
Long double door set	950.11.212

Packing: 1 piece

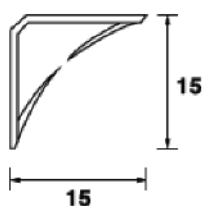

- > Fixing: Aggressive film backed self-adhesive.
- > Gap sizes (mm): LAS1515 - 3 mm
- > Finish: Standard colour: Black with black fins.  
White, grey, brown and clear available to special order.  
(note clear does not restrict light penetration).

### Batwing Seal (LAS1515) Medium Duty

Length mm	Cat. No.
1000	950.11.213
2100	950.11.214
2750	950.11.215
Single door set	950.11.216
Long single door set	950.11.217
Double door set	950.11.218
Long double door set	950.11.219

Packing: 1 piece

# SLIDE AND FOLD BY HÄFELE

**If you want to create a space that turns heads,  
Sliding and Folding systems are where it's at.**

Häfele's Slide and Fold catalogue includes installations from European giants HAWA and EKU, plus Häfele's own SLIDO range that you won't find anywhere else in New Zealand.

Häfele's Slide and Fold catalogue has everything you need to choose, use and refer sliding and folding systems for almost every building or furniture application you thought possible - and even ones you didn't.

The online catalogue includes all the links you need to refer to installation information, planning and CAD data.

**View it online at [www.hafele.co.nz](http://www.hafele.co.nz)**



LINKS TO CAD DATA



LINKS TO PRODUCT IMAGES



LINKS TO MOUNTING INSTRUCTIONS



LINKS TO PLANNING TOOLS



LINKS TO PRODUCT AND MOUNTING VIDEOS







RESIDENTIAL DOOR HARDWARE ESSENTIALS / 03.2018

**Häfele New Zealand Ltd.** | Auckland Head Office, 16 Accent Drive, East Tamaki, Auckland 2013 | Wellington Design Centre, The Wool Store, Level 1, 262 Thorndon Quay | Christchurch Design Centre, 5 Wigram Close, Sockburn  
**Phone:** 0800 442 335 | **Email:** [info@hafele.co.nz](mailto:info@hafele.co.nz) | [www.hafele.co.nz](http://www.hafele.co.nz)

**HÄFELE LOCATIONS:**

**New Zealand** | AUCKLAND | WELLINGTON | CHRISTCHURCH

**Australia** | MELBOURNE | SYDNEY | NEWCASTLE | BRISBANE | ADELAIDE | LAUNCESTON | HOBART | PERTH