

HÄFELE



2023 | www.hafele.co.nz

ENGINEERED
BY HÄFELE

MATRIX DRAWER SYSTEMS OPEN IN EVERY DIRECTION

Brought to you by Häfele

HÄFELE MATRIX DRAWER SYSTEMS

CONTENTS



MATRIX BOX S35

Technical detail and installation	4-7
Standard drawer set articles	8
Internal drawer fronts	9
Bulk drawer set articles	10
Infill panels and assembly aids	10



MATRIX BOX SLIM A30

Technical detail and installation	12-15
Standard drawer sets and internal drawers	16-18
Spare parts and accessories	19

MATRIX UNDERMOUNT RUNNERS FOR BOX DRAWERS

Matrix undermount A30 synchronised soft close runners	20
---	----



LAUNDRY AND WASTE BIN SOLUTIONS

Ninka One2Five	22
Ninka One2Laundry	22
Hailo Tandem 30F	23
Hailo individual pails and laundry hampers	23
Hailo foot pedal	23
Anti-slip mat, for use with bins or trays	23



DRAWER INSERTS

Ninka Cusio drawer inserts	24
Grip insert with non-slip coating	24
Scoop insert with movable dividers	25
Traditional plastic trays	25-26
Spice inserts	26
Sink waste cut outs	27



METALLA 310 SOFT CLOSE HINGES

Metalla hinges technical detail and installation	29
Metalla 110° soft close hinges	30
Metalla special angle soft close hinges	31-32
Metalla mount plates	32

FREE SPACE FLAP FITTINGS

Free Space technical detail and installation	33
Free Space flap fittings with standard opening	34
Free Space flap fittings with push to open	35



ENGINEERED
BY HÄFELE

MATRIX BOX S35

HÄFELE MATRIX BOX S35

TRIED AND TESTED

The Häfele Matrix Box S drawer system has been independently tested and passed the European DIN EN 15338 level 3 standards. This was achieved with a full 35 kg weight capacity over 60,000 opening and closing cycles - meaning Matrix Box S will be there for you through the life of your kitchen.



- > Features: 35 kg load capacity
Full extension runners with integrated soft-close
- > Mounting: Front fix brackets snap into drawer sides with
expanding dowel mounting onto the drawer front
- > Finish: Powder coated, white or matt black

DEFINITION

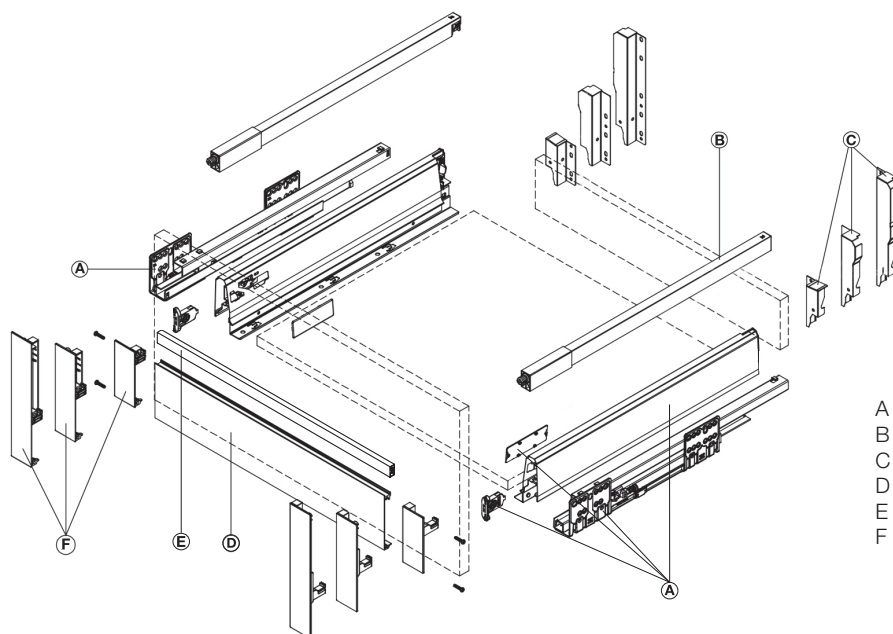

- A = Drawer set with cover caps and front brackets
- B = Gallery rails
- C = Back brackets
- D = Internal front panel
- E = Cross rail
- F = Internal front panel end caps

DRAWER SIDE DESIGN

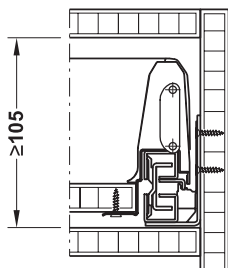
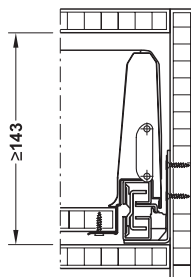
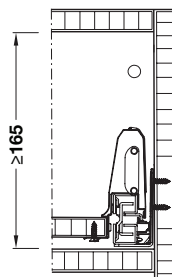
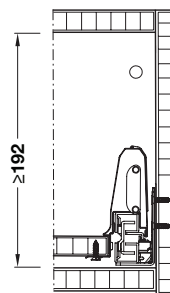
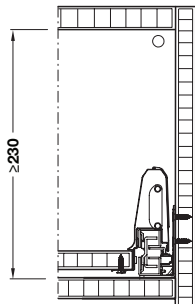
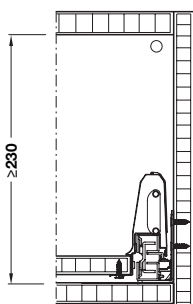
H84

H120

H135R

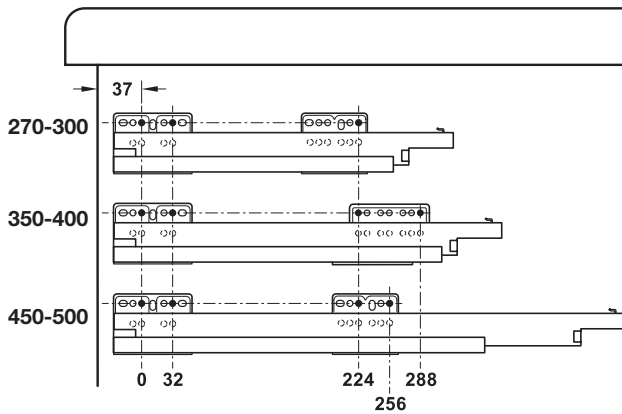
H167R

H199R

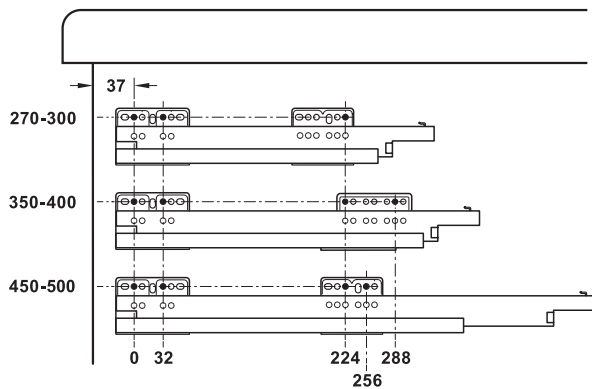
H199P

DRILLING PATTERN FOR CABINET

For drawer side height 84 mm and 120 mm with standard front
Load bearing capacity 35 kg:



Inner front:



CALCULATION OF THE INTERNAL DRAWER SPACE DIM.

Internal drawer width, e.g.:

External cabinet width 600 mm
 - (2 x side panel thickness) - (2 x 19 mm = 38 mm)
 - (2 x installation dimension) - (2 x 37.5 mm = 75 mm)
 = internal drawer width = 487 mm

External cabinet width mm	300	400	500	600	800
Side panel thickness mm	Internal drawer width mm				
16	193	293	393	493	693
19	187	287	387	487	687

Internal drawer depth, e.g.:

Nominal length cabinet runner 500 mm
 - installation dimension - 8 mm
 - rear panel thickness - 16 mm
 = internal drawer depth - 476 mm

INTERNAL CABINET DEPTH



Min. internal cabinet depth:

Standard front= nominal length NL + 16mm

Inner front = nominal length NL + 26mm

ADJUSTMENT FACILITIES

Front panel adjustment

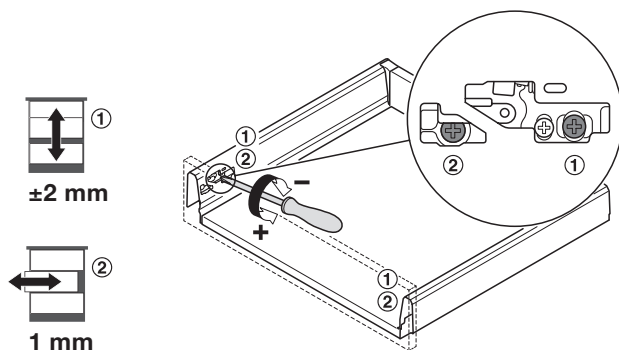

Front panel removal

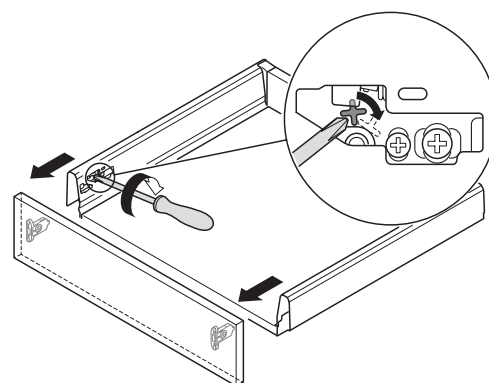

H84 / H120 DRAWER SET



H135R / H167R / H199R DRAWER SET



H199P DRAWER SET - INFILL PANELS



INSTALLATION OF THE DRAWER

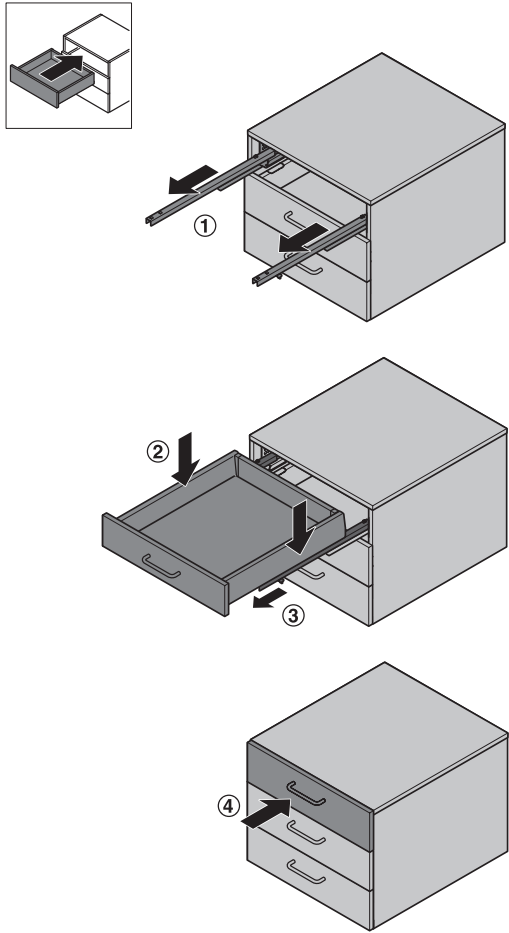

REMOVAL OF THE DRAWER

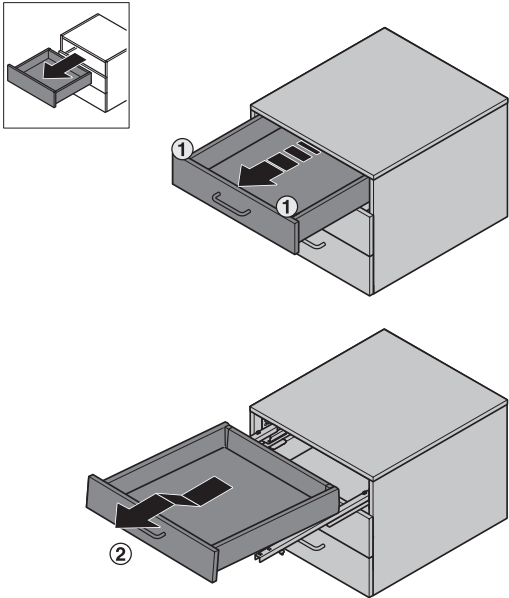

H84 DRAWER SET

Internal installation height

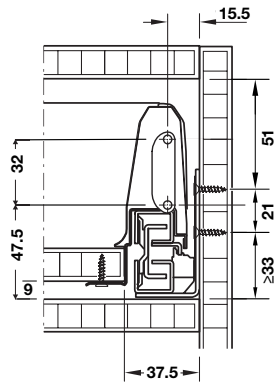

Rear panel installation dimensions

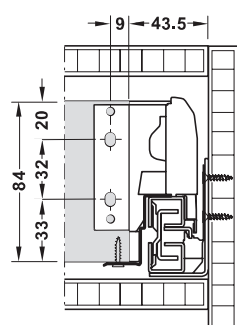

Drawer side height 84 mm

H120 DRAWER SET

Internal installation height

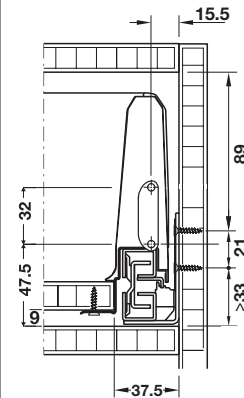

Rear panel installation dimensions

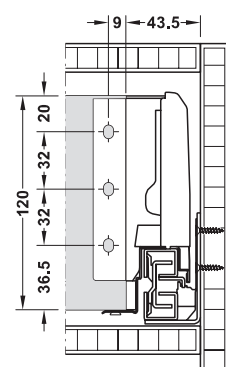

Drawer side height 120 mm

H135R DRAWER SET

Internal installation height

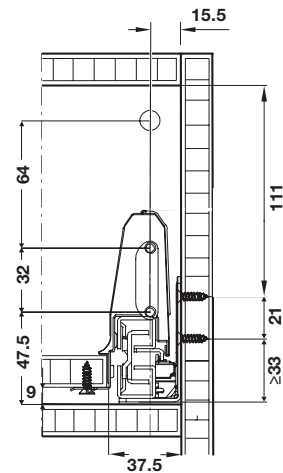

Rear panel installation dimensions

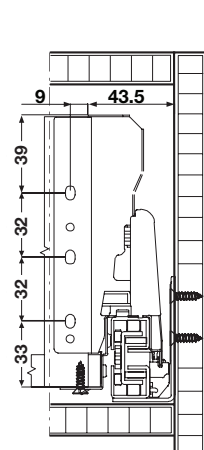

Drawer side height 84 mm, with rectangular railing

H167R DRAWER SET

Internal installation height

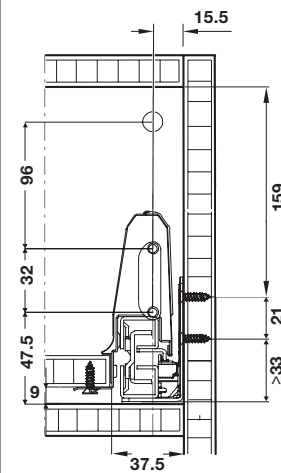

Rear panel installation dimensions

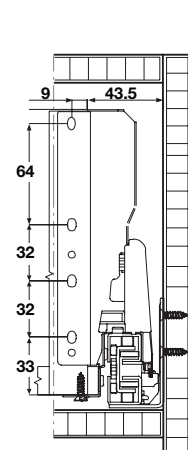

Drawer side height 84 mm, with rectangular railing

H199R DRAWER SET

Internal installation height

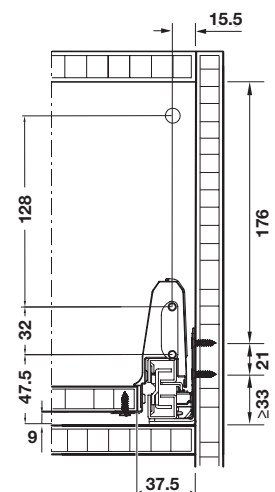

Rear panel installation dimensions

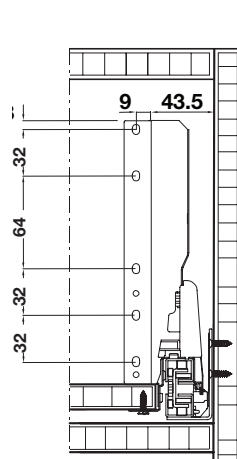

Drawer side height 84 mm, with rectangular railing

CUTTING DIMENSIONS FOR PANELS (16 MM)

Base panel

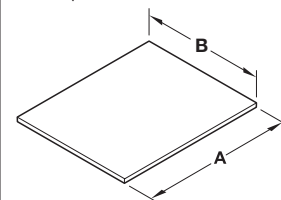

Rear panel

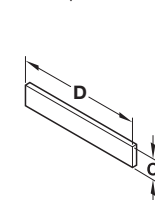

A = nominal length - 24 mm
B = internal cabinet width - 75 mm
C = rear panel height
D = internal cabinet width - 87 mm

Drawer side height	Rear panel height (C)
84 mm	84 mm
120 mm	120 mm
135 mm	135 mm
167 mm	167 mm
199 mm	199 mm

H84 STANDARD DRAWER SET

DRAWER SIDES WITH RUNNERS

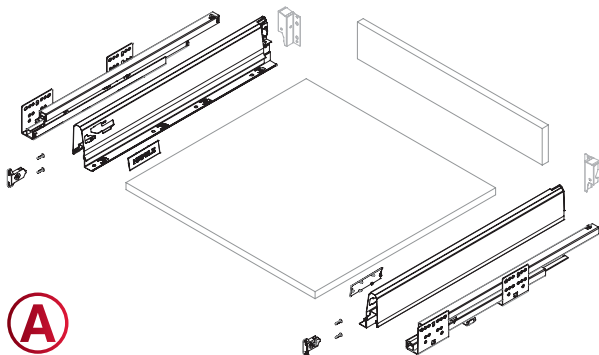

A

- > Material/Finish: Steel, Powder coated, white
Cabinet runner: Galvanised
- > Load capacity (kg): 35
- > Type of pull-out: Full extension, with integrated soft closing

Drawer length (mm)	Pallet quantity	Cat. No.
300	207	552.08.861
350	180	552.08.862
400	135	552.08.863
450	126	552.08.864
500	117	552.08.865
550	100	552.08.866

Packing: 1 set

+

Supplied with:

- > 1 Pair of drawer sides
- > 1 Pair of drawer runners
- > 2 Pieces of cover caps
- > 1 Pair of front fixing brackets - Expanding dowel

!

Note:

Back brackets and gallery rails ordered separately.

RECTANGULAR GALLERY RAIL SETS

For H135, H167 or H199 drawer sets.

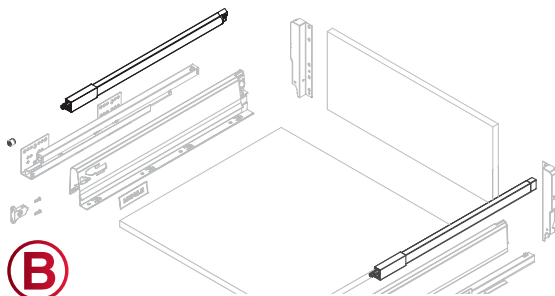

B

Gallery rail length (mm)	White
300	552.72.821
350	552.72.822
400	552.72.823
450	552.72.824
500	552.72.825
550	552.72.826

Packing: 1 and 25 pairs

+

Supplied with:

- > 1 Pair of gallery rails
- > 1 Pair of front brackets (expanding dowel and screw on)

BACK BRACKETS For H84 drawer sides

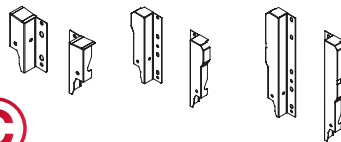

C

Height	Packing (pairs)	Cat. No.
H84	100	552.71.892
H135	50	552.69.297
H167	50	552.71.895
H199	40	552.71.894

Packing: 40 / 50 / 100 pairs

SIMPLE AS ...

A + B + C

H120 COMPLETE DRAWER SET

WITH DRAWER SIDES, RUNNERS AND BACK BRACKETS

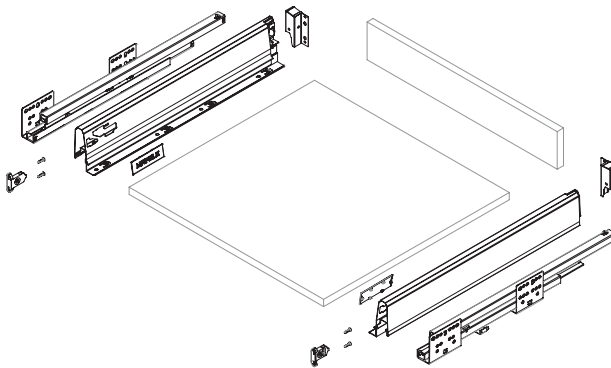

Drawer length (mm)	Pallet quantity	Cat. No.
350	134	552.04.752
500	89	552.04.755

Packing: 1 set

+

Supplied with:

- > 1 Pair of drawer sides
- > 1 Pair of drawer runners
- > 1 Pair of back panel brackets
- > 2 Pieces of cover caps
- > 1 Pair of front fixing brackets - Expanding dowel

!

Note:

Other sizes available on request. Pallet quantities apply.

INTERNAL DRAWER FRONTS

H84 INTERNAL FRONT PANEL SET

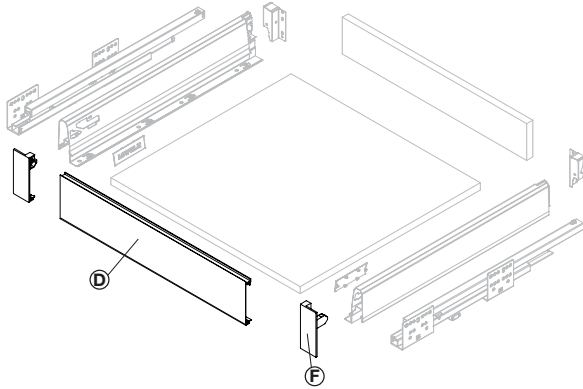

H135, H167, H199 INTERNAL FRONT PANEL SET With cross rail

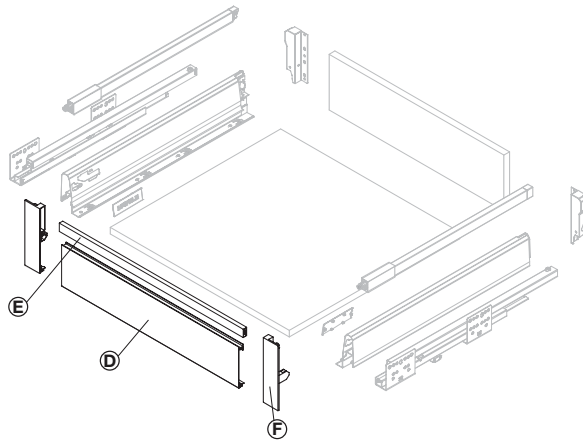

INTERNAL FRONT COMPONENTS Front panel, for H84 mm drawers



- > Area of application: Use with end caps (Order separately)
- > Material: Aluminium, powder coated white
- > Length: 1100

	Cat. No.
Ⓓ	552.69.881

Packing: 1 set



Note:
Panel length = Internal cabinet width less 87 mm

CROSS RAILS



- > Area of application: Use with end caps H135 and H199 (Order separately)
- > Material: Aluminium, powder coated white
- > Length: 1100

	Cat. No.
Ⓔ	552.72.817

Packing: 1 set



Note:
Cross rail length = Internal cabinet width less 71 mm

END CAPS

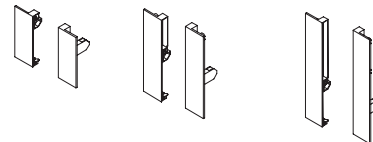

- > Area of application: Use with front panel and cross rail (Order separately)
- > Material: Plastic, white
- > Mounting: Screw fix to front panel and cross rail

	Height	Cat. No.
Ⓕ	H84	552.70.892
	H135	552.70.897
	H167	522.70.799
	H199	552.70.898

Packing: 1 pair

H199P INFILL SET



BOX SIDE PANELS

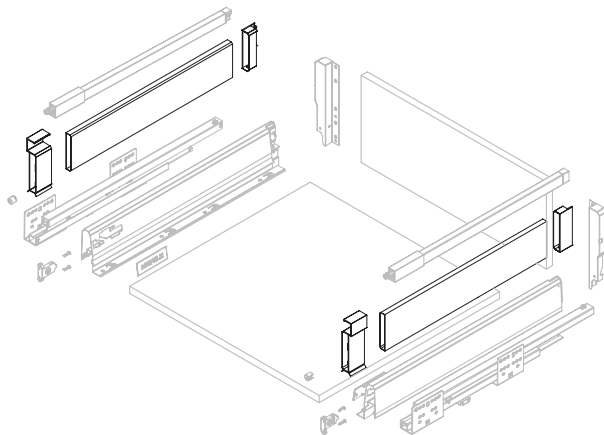

- > Area of application: Use with standard rectangular rail set (Order separately)
- > Version: For H199 drawer sets only
- > Material: Panel: Steel, powder coated white
Brackets: Plastic, white
- > Mounting: Clips onto back bracket/rectangular rail

Drawer length (mm)	Cat. No.
300	552.59.821
350	552.59.822
400	552.59.823
450	552.59.824
500	552.59.825
550	552.59.826

Packing: 1 and 10 pairs



Supplied with:

- > 1 Pair of box side panels
- > 1 Pair of fixing brackets



Note:

Drawer sides and runners must be ordered separately.

BULK TRADE PACKS

H84 DRAWER SIDES

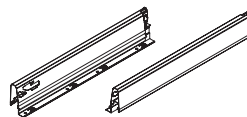

Drawer length (mm)	White	
	Right	Left
500	552.92.775	552.92.785

Packing: 20 pieces

35 KG DRAWER RUNNERS

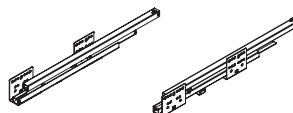

Drawer length (mm)	Right	Left
500	552.91.975	552.91.985

Packing: 20 pieces

COVER CAPS AND FRONT FIXING



Description	Packing	Cat. No.
Cover caps, white	1,000 pcs	552.91.790
Front brackets, expanding dowel	500 pcs	552.62.993
Front brackets, screw on	800 pcs	552.69.992

ASSEMBLY AIDS

DRAWER FRONT MARKING JIG



Compatible with	Cat. No.
16 mm and 18 mm drawer base panels	552.69.988

Packing: 1 piece

GALLERY RAIL MARKING JIG

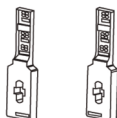

	Cat. No.
	552.69.989

Packing: 1 piece



MATRIX SLIMWALL



MATRIX BOX SLIM A

ELEGANT AND STREAMLINED



ADVANTAGES OF MATRIX BOX SLIM A



ELEGANT DESIGN

Side panels in slim, streamlined design in three drawer side heights (89/128/175 mm) with selected surfaces and optional push-to-open for handle-free furniture designs.



GENEROUS USAGE

More usable space in the drawer and easy fitting of inserts thanks to slim 90° inner drawer wall.



CONVINCING PERFORMANCE

Smooth closing due to runner with integrated soft closing mechanism. Now with Synchronization.



COMFORTABLE 4D-ADJUSTMENT

Access even in confined spaces thanks to height, depth and side adjustment underneath drawer and tilt adjustment inside the drawer.

HÄFELE MATRIX BOX SLIM A

DRAWER SIDE COLOUR AVAILABLE

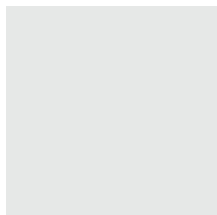

White matt



DEFINITION

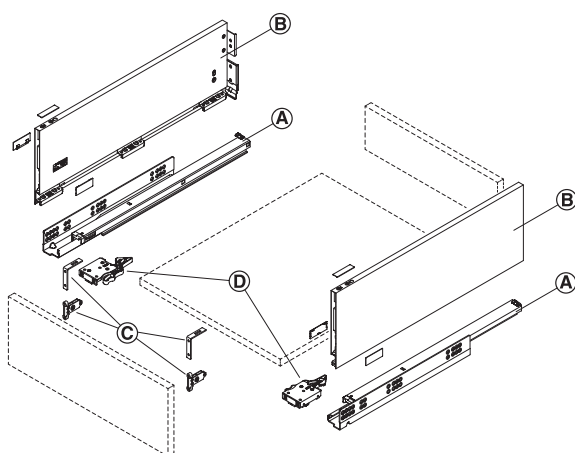

- A = Concealed runners
- B = Thin-walled drawer sides with cover caps
- C = Front fixing brackets
- D = Snap-in couplings

DRAWER SIDE DESIGN

H89

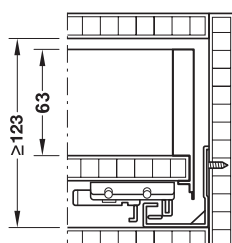

H128

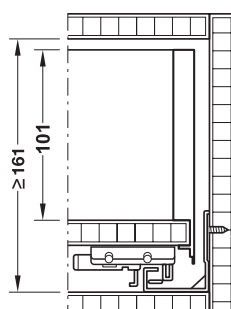

H175

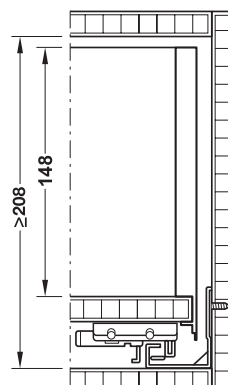

CUTTING DIMENSIONS FOR PANELS (PANEL THICKNESS OF 16 MM)

Base panel

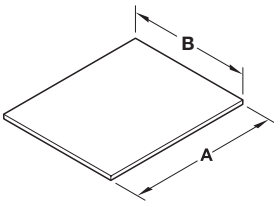

Rear panel

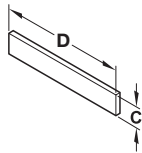

A = nominal length - 10 mm
B = internal cabinet width - 19 mm
C = rear panel height
D = internal cabinet width - 40 mm

Drawer side height	Load Bearing Capacity	Rear panel height (C)
84 mm	30 kg	63 mm
128 mm	30 kg	101 mm
175 mm	30 kg	148 mm

DRILLING PATTERN FOR CABINET

For drawer side height 89 mm, 128 mm and 175 mm

Standard front:

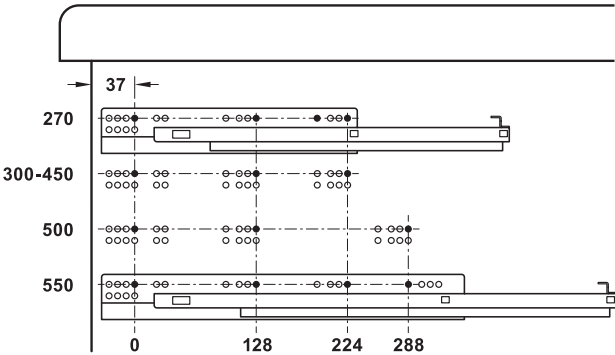

Front gap:
Softclose = 1 mm

Inner front:

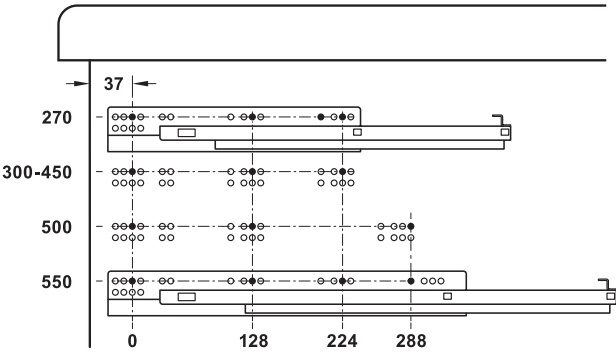

CALCULATION OF THE INTERNAL DRAWER SPACE DIM.

Internal drawer width, e.g.:

External cabinet width 600 mm
- (2 x side panel thickness) - (2 x 19 mm = 38 mm)
- (2 x installation dimension) - (2 x 20 mm = 40 mm)
= internal drawer width = 522 mm

External cabinet width mm	300	400	500	600	800
Side panel thickness mm	Internal drawer width mm				
16	228	328	428	528	728
19	222	322	422	522	722

Internal drawer depth, e.g.:

Nominal length cabinet runner 500 mm
- rear panel thickness - 16 mm
= internal drawer depth - 484 mm

INTERNAL CABINET DEPTH

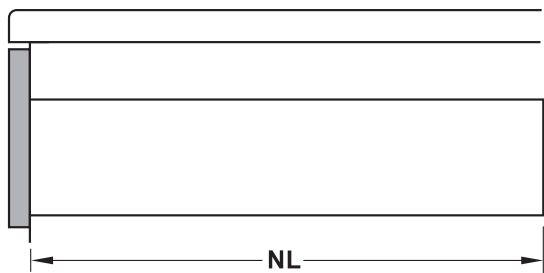

Min. internal cabinet depth:
Standard front = nominal length NL + 20mm
Inner front = nominal length NL + 30mm

ADJUSTMENT FACILITIES

Convenient height and side adjustment, tilt and front gap adjustment when installed.

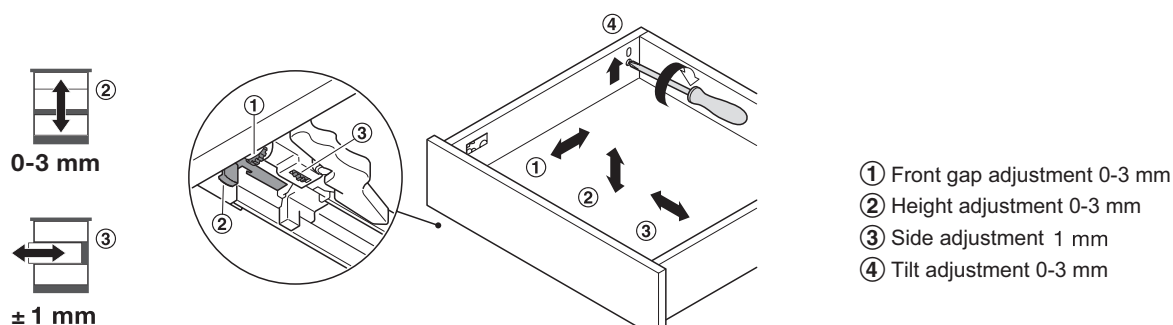

Front panel removal

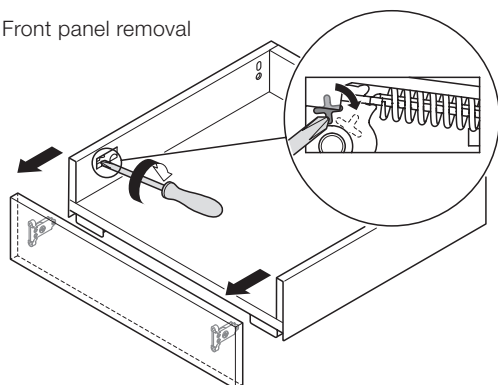

INSTALLATION AND REMOVAL OF THE DRAWER

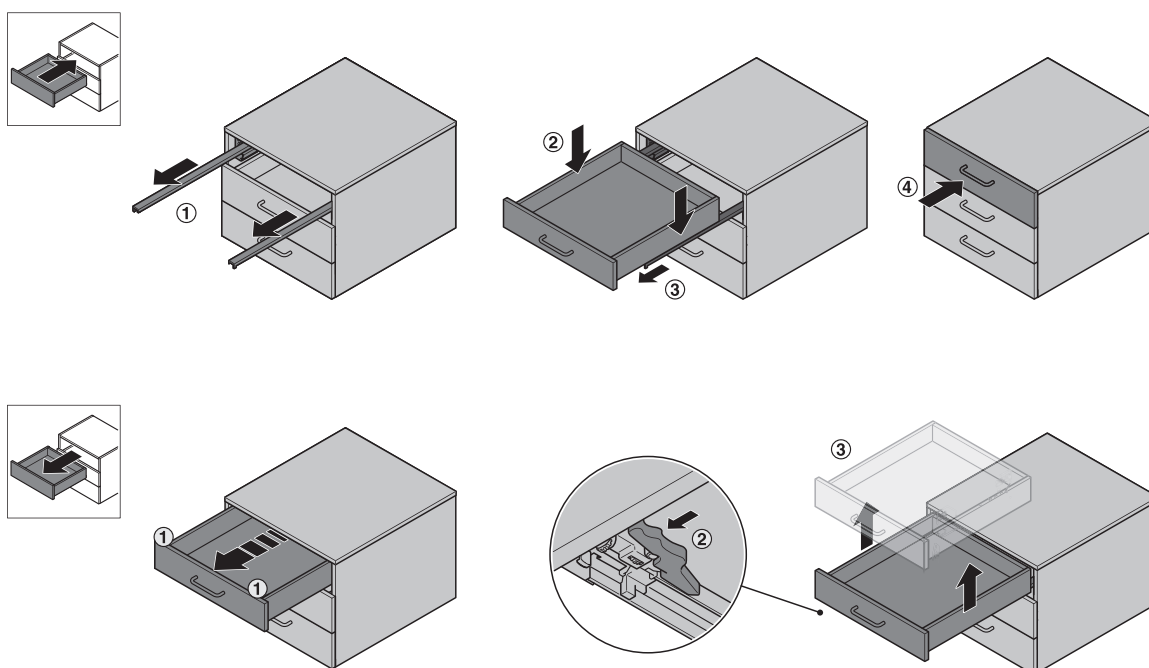

H89 DRAWER SET

DRAWER SIDE HEIGHT 89 MM

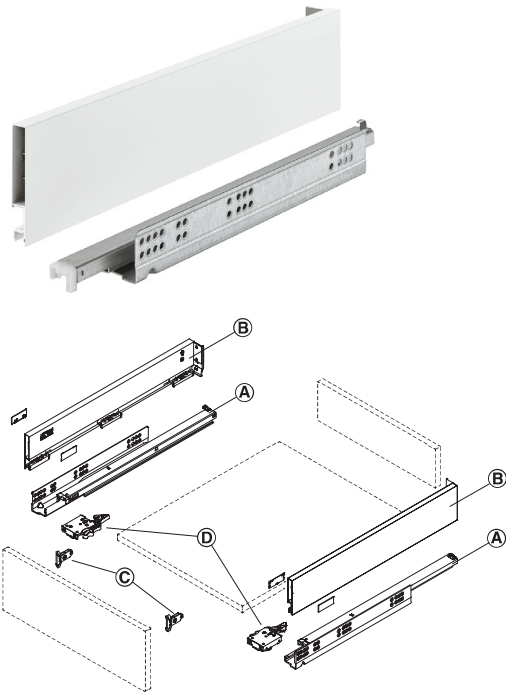

- (A) Concealed runner
- (B) Thin-walled drawer sides with cover caps
- (C) Front fixing bracket
- (D) Snap-in coupling

> Material:	Steel
> Finish:	Drawer sides: Powder coated, matt White Runners: Galvanised
> Load bearing capacity (kg):	30
> Version:	Slim wall drawer sides of 13 mm
> Type of pull-out:	Full extension, with integrated soft closing

Drawer length (mm)	Cat. No.
350	552.21.772
400	552.21.773
450	552.21.774
500	552.21.775
550	552.21.776

Packing: 4 sets



- Supplied with:**
- > 1 Pair of 89 mm high thin wall drawer sides with integrated back brackets
 - > 1 Pair of concealed runners, synchronised
 - > 1 Pair of cover caps
 - > 1 Pair of front fixing brackets, screw on
 - > 1 Pair of snap-in couplings with 3D adjustment

Internal installation height

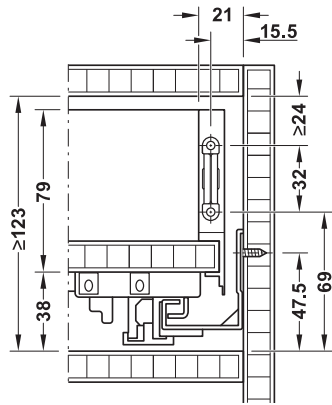

Rear panel dimensions

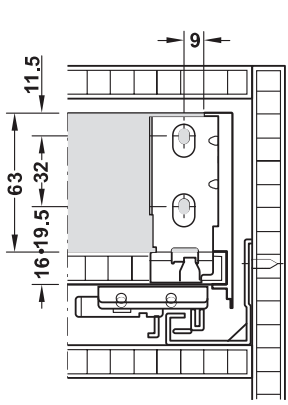

INTERNAL DRAWER FRONTS

FOR DRAWER SIDE HEIGHT 89 MM

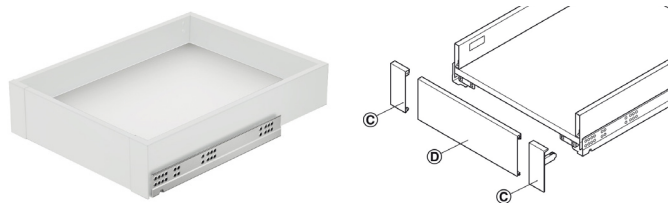

- (C) Panel holder
 - (D) Panel
- Length = internal cabinet width - 95 mm

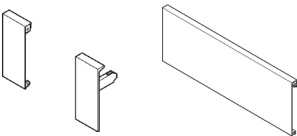

> Material:	Plastic, Front brackets: White Aluminium, Panel: White
-------------	---

Description	Packaging	Cat. No.
(C) Internal front brackets H89	1 or 50 pairs	552.31.790
(D) Drawer front panel (1100 mm)	1 or 10 pcs	552.31.709



Note:
Drawer sets must be ordered separately.
Panel must be cut to size.
Length = internal cabinet width - 95 mm.

H128 DRAWER SET

DRAWER SIDE HEIGHT 128 MM

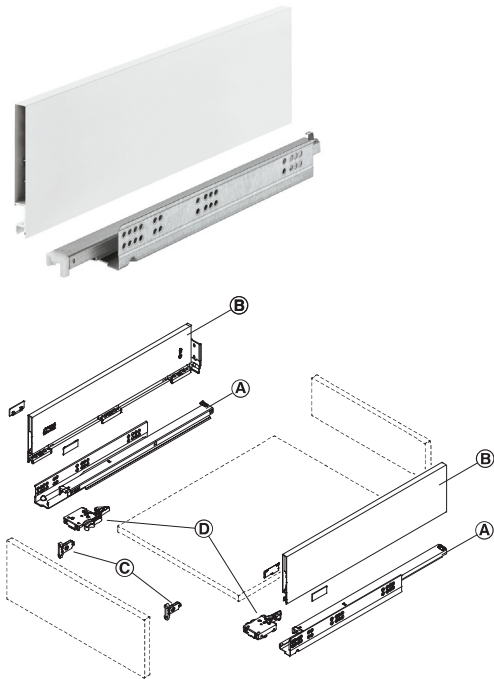

- (A) Concealed runner
- (B) Thin-walled drawer sides with cover caps
- (C) Front fixing bracket
- (D) Snap-in coupling

- > Material: Steel
- > Finish: Drawer sides: Powder coated, matt White
Runners: Galvanised
- > Load bearing capacity (kg): 30
- > Version: Slim wall drawer sides of 13 mm
- > Type of pull-out: Full extension, with integrated soft closing

Drawer length (mm)	Cat. No.
350	552.22.772
400	552.22.773
450	552.22.774
500	552.22.775
550	552.22.776

Packing: 4 sets



Supplied with:

- > 1 Pair of 128 mm high thin wall drawer sides with integrated back brackets
- > 1 Pair of concealed runners, synchronised
- > 1 Pair of cover caps
- > 1 Pair of front fixing brackets, screw on
- > 1 Pair of snap-in couplings with 3D adjustment

Internal installation height

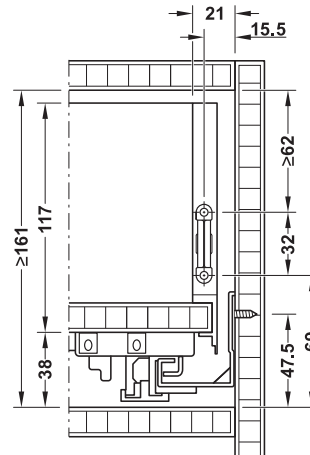

Rear panel dimensions

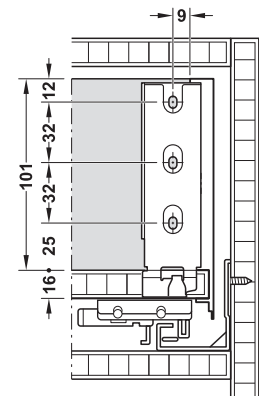

INTERNAL DRAWER FRONTS

FOR DRAWER SIDE HEIGHT 128 MM

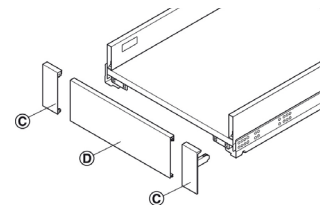

- (C) Panel holder
- (D) Panel
Length = internal cabinet width - 95 mm

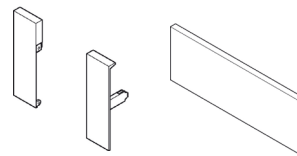

- > Material: Plastic, Front brackets: White
Aluminium, Panel: White

Description	Packaging	Cat. No.
(C) Internal front brackets H128	1 or 50 pairs	552.31.791
(D) Drawer front panel (1100 mm)	1 or 10 pcs	552.31.709



Note:

Drawer sets must be ordered separately.
Panel must be cut to size.
Length = internal cabinet width - 95 mm.

H175 DRAWER SET

DRAWER SIDE HEIGHT 175 MM

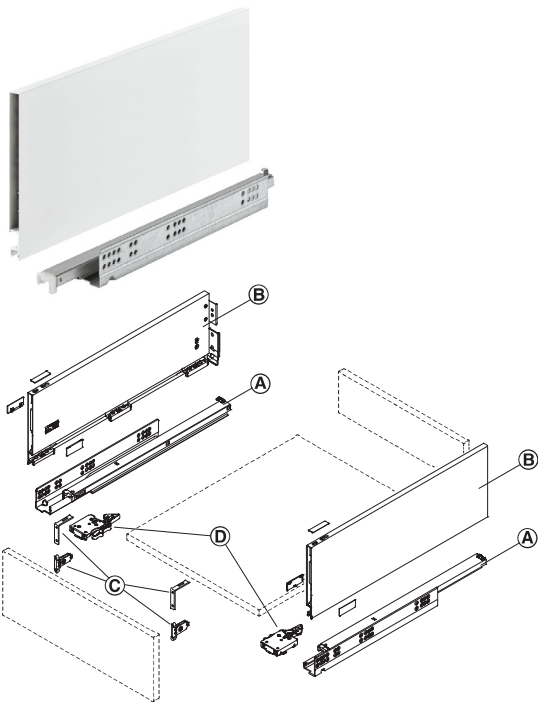

- A Concealed runner
- B Thin-walled drawer sides with cover caps
- C Front fixing bracket with top clip
- D Snap-in coupling

> Material:	Steel
> Finish:	Drawer sides: Powder coated, matt White Runners: Galvanised
> Load bearing capacity (kg):	30
> Version:	Slim wall drawer sides of 13 mm
> Type of pull-out:	Full extension, with integrated soft closing

Drawer length (mm)	Cat. No.
350	552.23.772
400	552.23.773
450	552.23.774
500	552.23.775
550	552.23.776

Packing: 4 sets



Supplied with:

- > 1 Pair of 175 mm high thin wall drawer sides with integrated back brackets.
- > 1 Pair of concealed runners, synchronised
- > 1 Pair of cover caps
- > 1 Pair of front fixing brackets, screw on
- > 1 Pair of L-shaped drawer supports
- > 1 Pair of snap-in couplings with 3D adjustment

Internal installation height

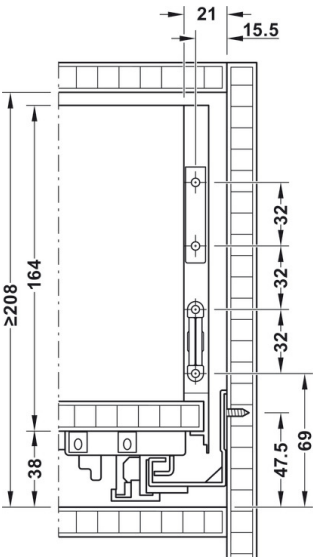

Rear panel dimensions

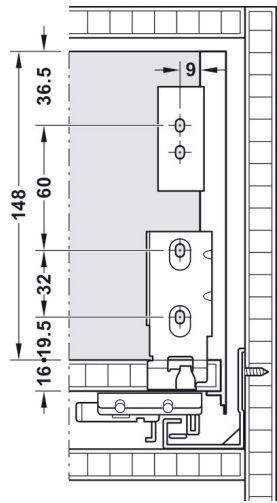

INTERNAL DRAWER FRONTS

FOR DRAWER SIDE HEIGHT 175 MM

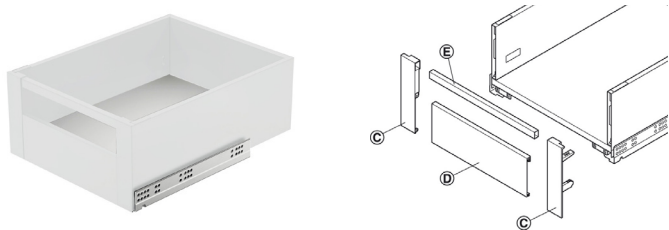

- C Panel holder
- D Panel
Length = internal cabinet width - 95 mm
- E Cross rail
Length = internal cabinet width - 47 mm

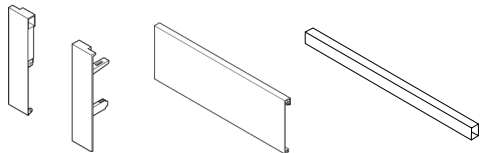

> Material:	Plastic, Front brackets: White Aluminium, Panel: White
-------------	---

Description	Packaging	Cat. No.
C Internal front brackets H175	1 or 50 pair	552.31.792
D Drawer front panel (1100 mm)	1 or 10 pcs	552.31.709
E Cross rail (1100 mm)	1 or 30 pcs	552.31.719



Note:
Drawer sets must be ordered separately.
Panel must be cut to size,
Panel ICW-95 mm, Cross Rail ICW-47 mm

SPARE PARTS

COVER CAP



> Material: Plastic

Finish	Cat. No.
White	552.31.770

Packing: 1 piece

FRONT BRACKETS



> Installation: Screw fixing
> Material: Plastic and metal

For drawer height (mm)	Cat. No.
89, 128 and 175	552.31.951

Packing: 1 pair

FRONT BRACKETS WITH TOP CLIP



> Installation: Screw fixing
> Material: Metal

For drawer height (mm)	Cat. No.
175	552.31.952

Packing: 1 set

ADDITIONAL BACK PANEL FIXING CLIPS



> Material: Plastic
> Installation: For screw fixing to drawer base and back panel

Finish	Cat. No.
Black	552.31.689

Packing: 20 pieces

3D CLIPS, FOR MATRIX BOX A RUNNERS



	Cat. No.
	433.03.191

Packing: 1 pair

HÄFELE MATRIX RUNNER UM A CONCEALED RUNNER

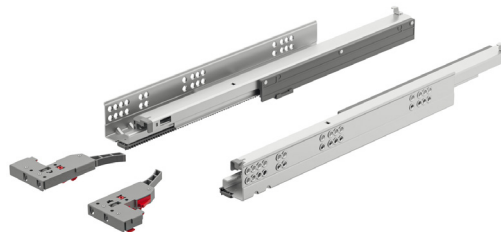

Drawer length (mm)	Cabinet depth (mm)	Extension length AL (mm)	Cat. No.
With self closing and soft closing mechanism			
350	368	333	433.03.652
400	418	383	433.03.653
450	468	433	433.03.654
500	518	483	433.03.655
550	568	533	433.03.656

Packing: 1 or 4 pairs



Supplied with:

- > 1 Pair of runners
- > 1 Coupling for full extension

UNDERMOUNT RUNNERS

MATRIX RUNNER FOR TIMBER BOX DRAWERS

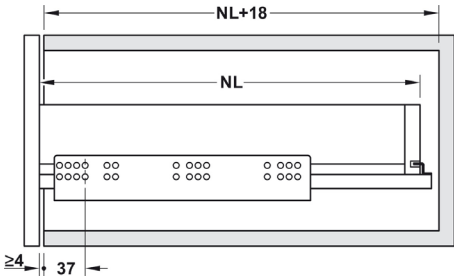
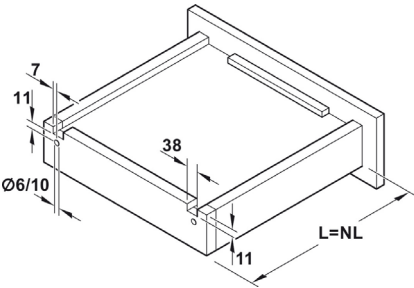

- > Material: Steel
- > Finish: Zinc plated
- > Dimensions (mm): Max. drawer width SB = internal cabinet width - 42 mm + 2 x drawer side panel thickness
- > Load bearing cap. (kg): 30
- > For side panel thickness: ≤16 mm
- > Version: With soft and self closing mechanism, synchronised running

Drawer length (mm)	Cabinet depth (mm)	Extension length AL (mm)	Cat. No.
With self closing and soft closing mechanism			
350	368	333	433.03.652
400	418	383	433.03.653
450	468	433	433.03.654
500	518	483	433.03.655
550	568	533	433.03.656

Packing: 1 or 4 pairs



- Supplied with:**
- > 1 Pair of runners
 - > 1 Coupling for full extension

Installation

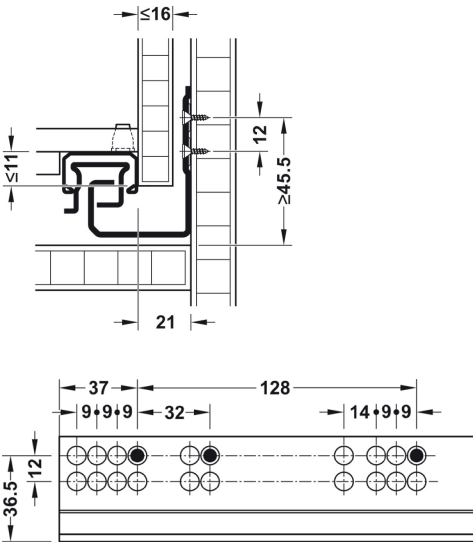



DRAWER INSERTS AND WASTE BINS

NINKA ONE2FIVE WASTE SYSTEM

TO SUIT HÄFELE MATRIX BOX S35 DRAWERS



- > Features: Designed to sit in a hanging frame mounted on Häfele Matrix Box S35 drawers
- > Finish: Dark Grey
- > Drawer depth (mm): 500

Description	Cat. No.
One2Five frame, 400 mm cabinet width	502.91.483
One2Five frame, 450 mm cabinet width	502.91.484

Packing: 1 piece



Note:
Please order drawer set separately.
Cover plate, pails and individual bin lid not included.
All dimensions allow for 16 mm side panels.

NINKA COVER PLATE AND SUSPENSION RAIL



- > Finish: Dark Grey

Description	Cat. No.
Cover plate 450 mm cabinet	502.87.424
Suspension rail (2 required)	502.87.490

Packing: 1 piece (2 pieces required per lid per cover plate)

NINKA PAILS



Description	Lids Cat. No.	Pails Cat. No.
Small (8 litre)	502.90.601	502.87.601
Large (17 litre)	502.90.602	502.87.602
Large (26 litre)	502.90.603	502.87.602

Packing: 1 piece

NINKA ONE2LAUNDRY SYSTEM

TO SUIT HÄFELE MATRIX BOX S35 DRAWERS



- > Features: Ergonomic basket handles for easy removal
- > Area of application: To suit Häfele Matrix S35 with 500mm depth
- > Finish: White
- > Cabinet width (mm): 450

Description	Cat. No.
Top plate - White	502.72.784
Laundry basket 55L - White	502.72.996
One2Five frame - Light grey	502.72.554

Packing: 1 piece



Note:
Please note drawer set must be ordered separately.
One2Five frame covered by a top plate.
Only stabiliser brackets are visible (as per image).
All 3 components must be ordered.

HAILO TANDEM 30F WASTE BIN

FOR CARCASE WIDTH 300 MM, MOUNTED IN DRAWER

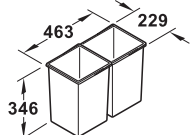

- > Area of application: For installation in drawer boxes
- > Material: Frame: Steel
Pails: Plastic
- > Finish: Steel bracket, powder-coated dark grey, dark grey plastic cover plate and pails
- > Suitable for: All drawers with a length of 500 mm and above
- > Mounting: Screw fixing to drawer base

	Cat. No.
	502.70.301

Packing: 1 piece

HAILO DROP IN OPTIONS

FOR 300 MM CABINETS AND ABOVE



- > Area of application: Economical option for dropping into drawer bases with or without anti slip mat
- > Material: Plastic
- > Finish: Waste bin and lid: Light grey
Laundry hamper: White
- > Dimensions (mm): Waste bin: 233 x 226 x 350
(W x D x H) Laundry hamper: 255 x 375 x 510

Description	Cat. No.
(A) Lid for waste bin	502.70.935
(B) Waste bin 15 L	502.73.994
(C) Laundry hamper 33 L	502.72.990

Packing: 1 piece

ACCESSORIES

HAILO FOOT PEDAL DOOR OPENER

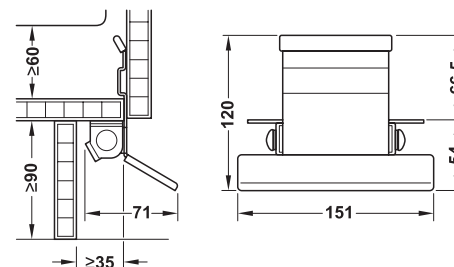

- > Area of application: For hands-free opening of waste bins mounted behind fixed panels. Suitable for self closing and soft closing waste bins. Can be retrofitted
- > Material: Stainless steel

	Cat. No.
	503.02.999

Packing: 1 piece

DESIGNER ANTI-SLIP MAT

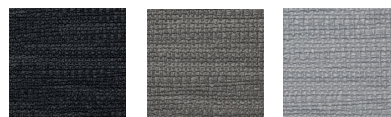

- > Length (m): 10

Width (mm)	Black	Umber Grey	Silver Grey
500	547.92.329	547.92.528	547.92.429
550	-	547.92.588	-

Packing: 1 piece

CUTLERY TRAYS

NINKA CUISIO CUTLERY TRAYS
For Häfele Matrix S35 drawers

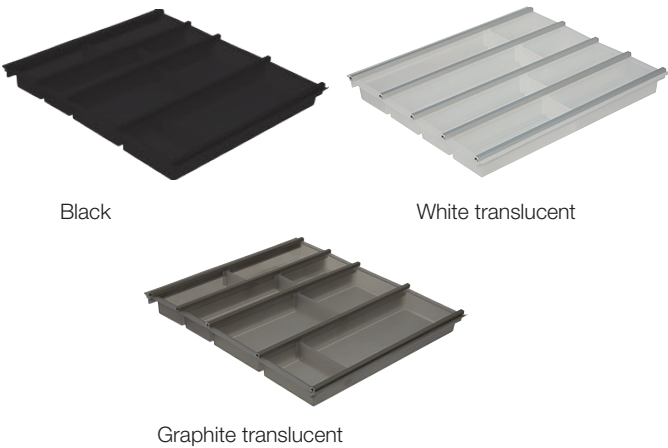

Tray configuration

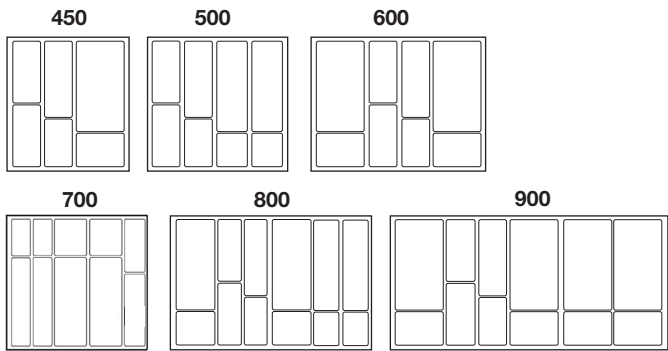

> Area of application:	Suitable for drawers with a depth of 500 mm
> Material:	Plastic (injection moulded) and aluminium
> Finish*:	White translucent and Silver; Graphite translucent and Stainless steel; or Black
> Depth (mm):	473
> Height (mm):	55

For carcase width (mm)	Black	White Translucent	Graphite Translucent
450	550.28.444	556.90.732	-
500	550.28.445	556.90.733	-
600	550.28.447	556.90.734	558.90.334
700	550.28.448	556.90.739	-
800	550.28.450	556.90.735	558.90.335
900	550.28.449	556.90.736	-

Packing: 1 piece

GRIP CUTLERY TRAY

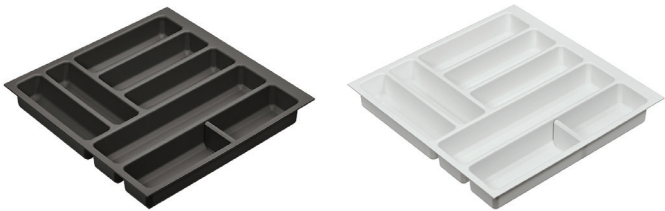

For cabinet width 600 mm

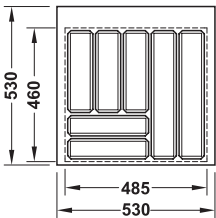

For cabinet width 800 mm

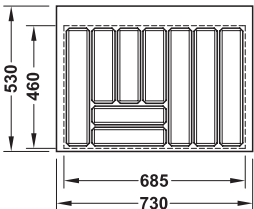

For cabinet width 900 mm

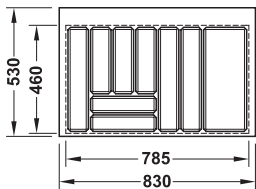

> Area of application:	Suitable for drawers with a depth of 500 mm
> Material:	Plastic
> Finish:	Anthracite pearl or white
> Height (mm):	40 or 52
> Features:	Non-slip surface coating (for Anthracite pearl colour only)

For cabinet width (mm)	Height (mm)	Anthracite pearl	White
600	52	556.60.316	556.60.716
800	52	556.60.317	556.60.717
900	52	556.60.318	556.60.718

Packing: 1 piece



Note: Non-slip surface coating available for Anthracite pearl colour only.

GRIP DIVIDER



> Area of application:	For subdividing cutlery insert with height of 52 mm
> Material:	Plastic
> Finish:	Anthracite or white
> Height (mm):	50

	Anthracite	White
	556.60.349	556.60.749

Packing: 1 piece

SCOOP CUTLERY TRAY

For Häfele Matrix Box S35 drawers



For cabinet width 450 mm

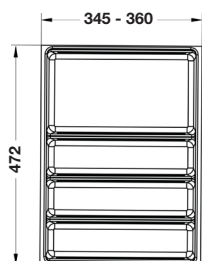

For cabinet width 600 mm

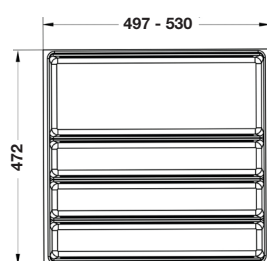

For cabinet width 900 mm

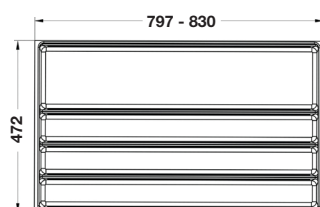

- > Area of application: For Häfele Matrix Box S35 drawers with a depth of 500 mm
- > Material: Plastic, vacuum formed
- > Finish: White
- > Height (mm): 62
- > Insert depth (mm): 472
- > Thickness (mm): 2.5

To suit cabinet width (mm)	Cat. No.
450	556.02.703
600	556.02.706
900	556.02.709

Packing: 1 piece

DIVIDER SET FOR SCOOP CUTLERY TRAY



- > Area of application: For subdividing Scoop cutlery insert
- > Features: Plastic
- > Material: White

	Cat. No.
	556.02.790

Packing: 1 set

CLASSICO 500 CUTLERY TRAY



400 mm

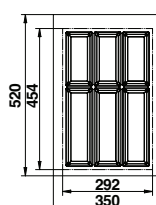

450 mm

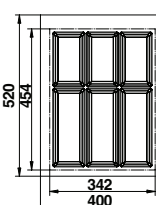

500 mm

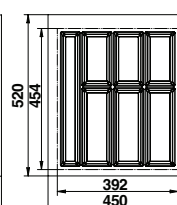

600 mm

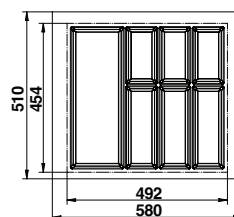

- > Area of application: Suitable for drawer depth of 500 mm
- > Material: Plastic, vacuum formed
- > Finish: White
- > Height (mm): 51
- > Insert depth (mm): 520
- > Thickness (mm): 2.5

To suit cabinet width (mm)	Actual insert width (mm)	Cat. No.
400	292 - 350	556.52.722
450	342 - 450	556.52.723
500	392 - 450	556.52.724
600	492 - 580	556.52.726

Packing: 1 piece

BASIC CUTLERY TRAY

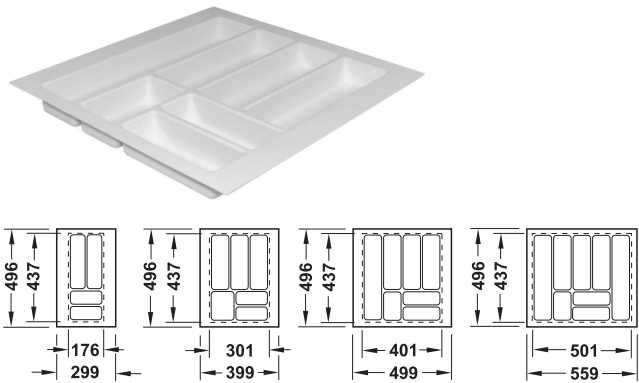

- > Area of application: Suitable for drawers with a depth of 500 mm
- > Material: Plastic (injection moulded)
- > Thickness (mm): 2.5
- > Finish: White
- > Height (mm): 50

To suit cabinet width (mm)	Insert width (mm)	Cat. No.
300	176 - 299	556.60.752
450	301 - 399	556.60.761
500	401 - 499	556.60.770
600	501 - 559	556.60.789

Packing: 1 Piece

EXCEL UTENSIL TRAY

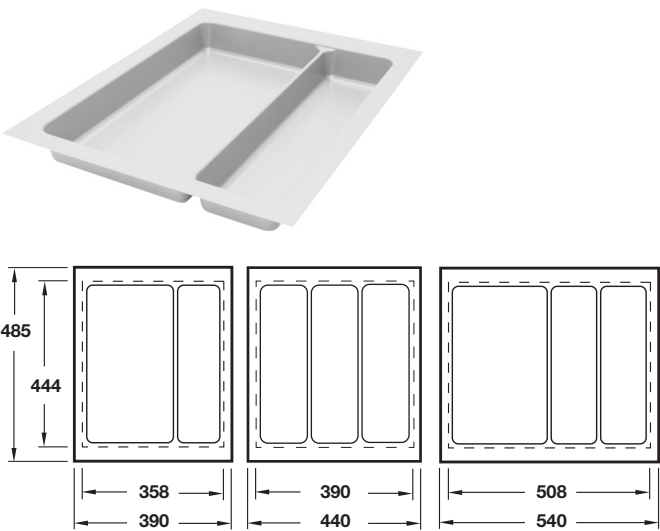

- > Area of application: For drawers with a depth of 450 or 500 mm
- > Material: Plastic (vacuum formed)
- > Finish: White
- > Version: With wide edge for cutting to drawer size
- > Height (mm): 57
- > Thickness (mm): 2.5

To suit cabinet width (mm)	Insert width (mm)	Insert depth (mm)	Cat. No.
450	390	485	556.65.748
500	440		556.65.757
600	540		556.65.766

Packing: 1 piece

SPICE INSERTS

SALSA EXCEL SPICE INSERT

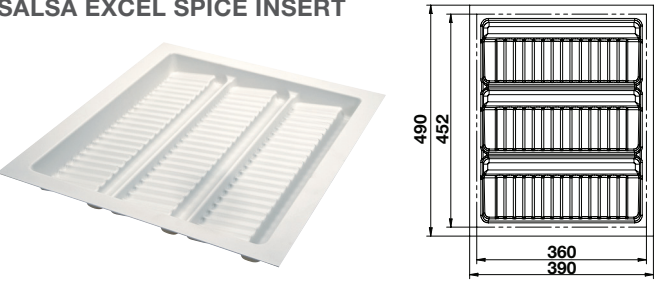

- > Area of application: Suitable for drawers with a depth of 500 mm
- > Material: Plastic (vacuum formed)
- > Finish: White
- > Height (mm): 50
- > Thickness (mm): 2.5

To suit cabinet width (mm)	Insert width (mm)	Insert depth (mm)	Cat. No.
450	390	490	556.63.753

Packing: 1 piece

SALSA PRO SPICE DRAWER TRAY

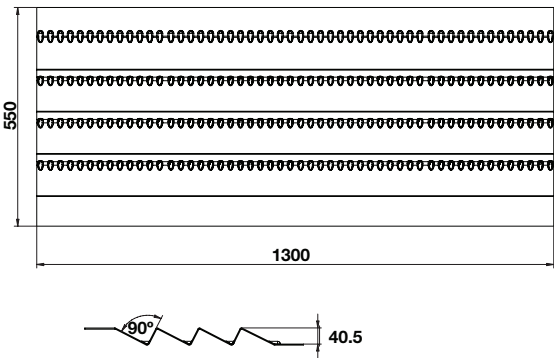

- > Area of application: For cut to size storage of spice jars
- > Material: Plastic (vacuum formed)
- > Finish: White
- > Inside drawer height (mm): Min. 83
- > Thickness (mm): 3

Insert width (mm)	Insert depth (mm)	Cat. No.
1300	550	556.79.706

Packing: 1 piece

INSERT FOR WASTE CUT OUTS

NINKA BANIO FRAME SET

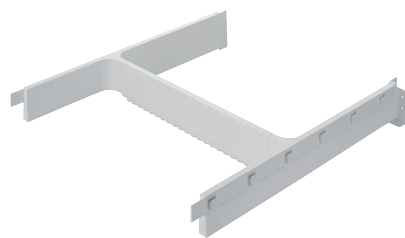

- > Area of application: Suitable for undersink drawers
- > Version: Length and width adjustable by cutting the centre and side components
- > Material: Plastic
- > Finish: White or Dark Grey

Finish	Cat. No.
White	556.23.704

Packing: 20 pieces



Supplied with:

- > 2 Side components
- > 1 Centre component
- > 2 Positioning strips
- > 2 Rear panel brackets

INSERT FOR WASTE TRAP CUT-OUT

For panel thickness 16 mm



Installation

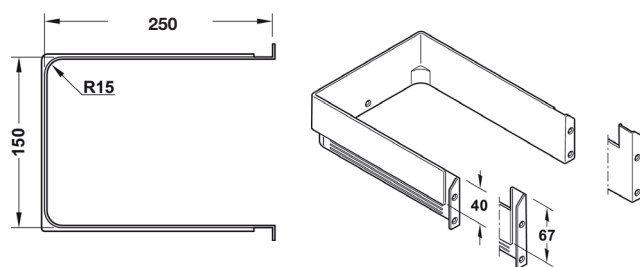

- > Features: Inserts match the colours of the Matrix Box systems
- > Length (mm): 250
- > Material: Plastic
- > Finish: White
- > For panel thickness (mm): 16

Height (mm)	Cat. No.
40	551.63.721
67	551.63.731

Packing: 1 piece



Note:

Additional edging of the panel around the waste trap cut-out is not necessary.

FLEXI SINK UNDERSINK DRAWER INSERT

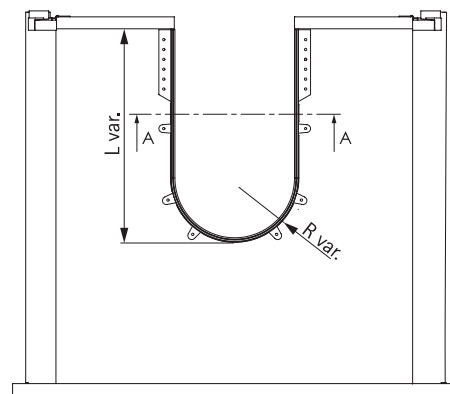
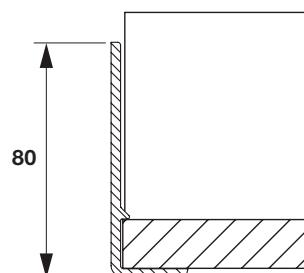
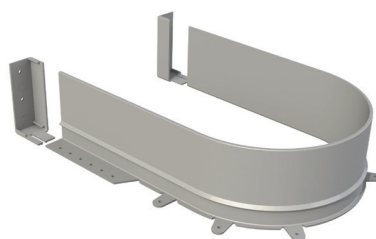

- > Area of application: Suitable for undersink drawers
- > Height x Length (mm): 80 x 680
- > Version: Length adjustable by cutting-to-size
- > Material: Plastic
- > Finish: White

Cat. No.
547.66.772

Packing: 1 piece



Note:

Minimum radius = 70 mm



HINGES AND FLAP FITTINGS

METALLA HINGES

DRILLING PATTERNS

For Screw fixing

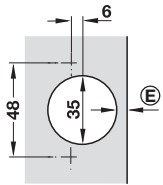

Cruciform mounting plate

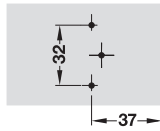

For Knock-in

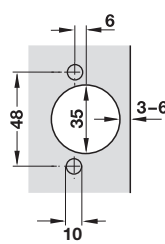

DETERMINATION OF REQUIRED MINIMUM GAP

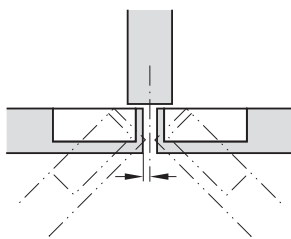

Minimum gap

The required minimum gap is dependent on the hinge type, the distance to cup and the door thickness. Once the distance to cup and the door thickness have been determined, the minimum gap can be looked up in the application table.

Example

Once the door overlay and the distance to cup have been determined, the distance can be looked up in the application table. In the example the door overlay is defined at 17 mm and the distance to cup at 6 mm. This produces a mounting plate distance of 2 mm.

Door thickness (mm)	Distance to cup (mm) ⑤			
	3	4	5	6
16	1.2	1.2	1.1	1.1
18	1.7	1.7	1.6	1.6
19	2.0	2.0	1.9	1.9
20	2.4	2.3	2.2	2.2
22	3.3	3.1	3.0	2.9
24	4.5	4.2	4.0	3.9

CHOICE OF MOUNTING PLATE

The different spacing heights of the mounting plates allow adjustments to be made to the door overlay. The dimension of the distance results from the thickness of the mounting plate. The starting point for determining the required distance is the required mounting method with a defined door overlay.

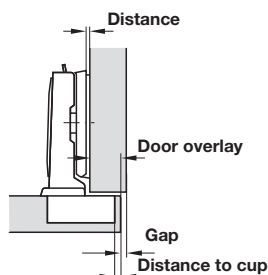

Example

With door overlay of 17 mm and a distance to cup of 6 mm, a mounting plate with distance 2 mm has to be chosen.

Door overlay (mm)									
12	13	14	15	16	17	18	19	20	
				3	4	5	6	7	0
		3	4	5	6	7			2
	3	4	5	6	7				4
Distance to cup (mm)					Mounting plate distance (mm)				

NUMBER OF CONCEALED HINGES PER DOOR

The values in the table are sample measurements. A trial mounting is recommended. The number of concealed hinges per door depends on:

Door width and height | Door weight | Door material

According to the example diagram, with a door height of 1500 mm and a door weight of 7 - 12 kg, three concealed hinges have to be fitted.

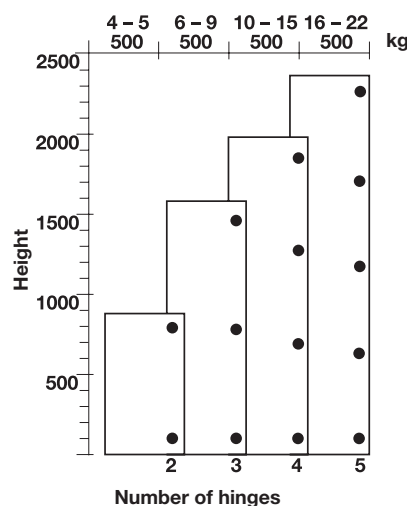

METALLA 310 SM 110° HINGES



- > Material: Steel cup and hinge arm
- > Finish: Nickel-plated
- > Cup fixing: For screw fixing or knock in
- > Drilling depth (mm): Hinge cup 12.0 mm
- > Adjusting facility: Side adjustment ± 3.0 mm
Height adjustment ± 2 mm (via mounting plate)
Depth adjustment ± 2 mm
- > Door thickness (mm): 14-26 (depending on application)
- > Drilling pattern: 48/6 with or without 10 mm dowels

FULL OVERLAY MOUNTING

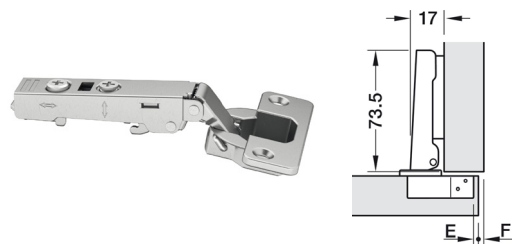

Door overlay (mm)

10	11	12	13	14	15	16	17	18	
				3	4	5	6	7	0
		3	4	5	6	7			2
3	4	5	6	7					4
Distance to cup (mm)						Mounting plate distance (mm)			

Cup fixing	Version	Cat. No.
Drilling pattern 48/6		
Screw fixing	With soft close	311.04.249
Screw fixing	Without soft close	311.64.907
Knock-in		311.64.916

Packing: 250 pieces

COVER CAP FOR METALLA 310 HINGES



Version	Cat. No.
Full overlay mounting	311.91.520

Packing: 250 pieces

HALF OVERLAY MOUNTING

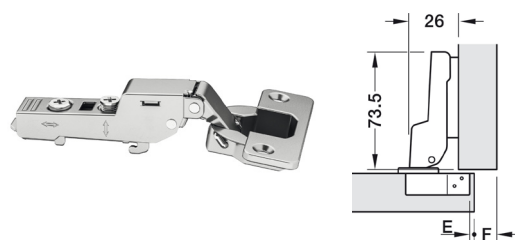

Door overlay (mm)

1	2	3	4	5	6	7	8	9	
			3	4	5	6	7		0
		3	4	5	6	7			2
3	4	5	6	7					4
Distance to cup (mm)						Mounting plate distance (mm)			

Cup fixing	Version	Cat. No.
Drilling pattern 48/6		
Screw fixing	With soft close	311.04.252
Screw fixing	Without soft close	311.64.905
Knock-in		311.64.914

Packing: 250 pieces

INSET MOUNTING

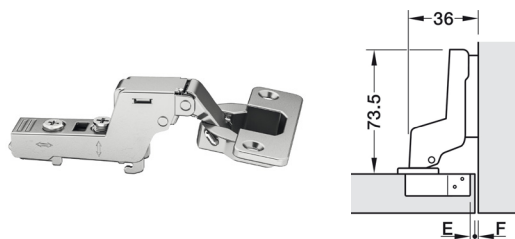

Door overlay (mm)

-8	-7	-6	-5	-4	-3	-2	-1	0	
				3	4	5	6	7	0
		3	4	5	6	7			2
3	4	5	6	7					4
Distance to cup (mm)						Mounting plate distance (mm)			

Cup fixing	Version	Cat. No.
Drilling pattern 48/6		
Screw fixing	With soft close	311.04.255
	Without soft close	311.64.903

Packing: 250 pieces

METALLA 310 SM 155° HINGES

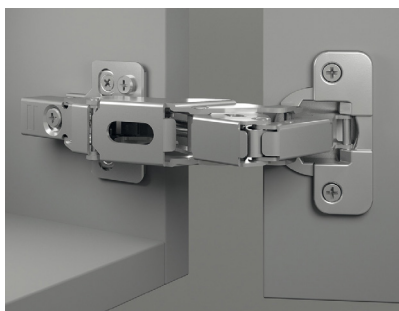

- > Material: Steel cup and hinge arm
- > Finish: Nickel-plated
- > Cup fixing: For screw fixing or knock in
- > Drilling depth (mm): Hinge cup 12.0 mm
- > Adjusting facility: Side adjustment ± 3.0 mm
Height adjustment ± 2 mm (via mounting plate)
Depth adjustment ± 2 mm
- > Door thickness (mm): 14-26 (depending on application)
- > Drilling pattern: 48/6 with or without 10 mm dowels

FULL OVERLAY MOUNTING

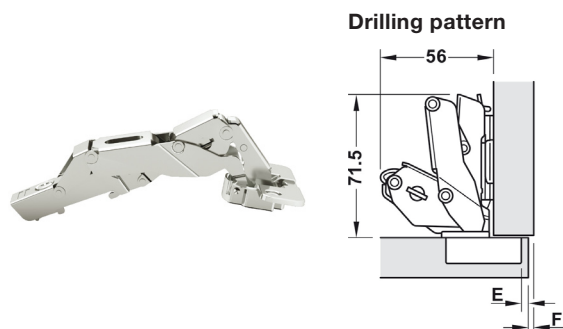

Door overlay (mm)

13	14	15	16	17	18	19	20	21	
				3	4	5	6	7	0
			3	4	5	6	7		2
	3	4	5	6	7				4
Distance to cup (mm)						Mounting plate distance (mm)			

Cup fixing	Version	Cat. No.
Drilling pattern 48/6		
Screw fixing	With soft close	311.63.731
Screw fixing	Without soft close	311.63.740
Knock-in		311.63.670

Packing: 50 pieces

HALF OVERLAY MOUNTING

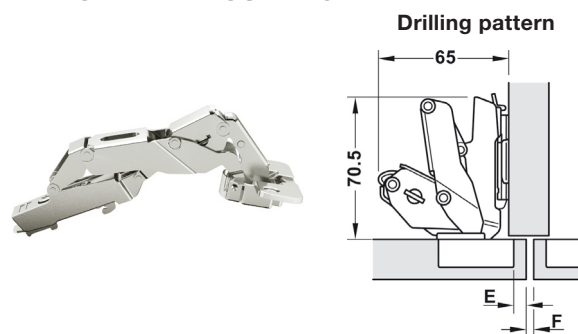

Door overlay (mm)

4	5	6	7	8	9	10	11	12	
				3	4	5	6	7	0
		3	4	5	6	7			2
3	4	5	6	7					4
Distance to cup (mm)							Mounting plate distance (mm)		

Cup fixing	Version	Cat. No.
Drilling pattern 48/6		
Screw fixing	Without soft close	311.63.754
	With soft close	311.63.734

Packing: 50 pieces

METALLA 310 SM 135° HINGES

PIECUT CORNER DOOR HINGES

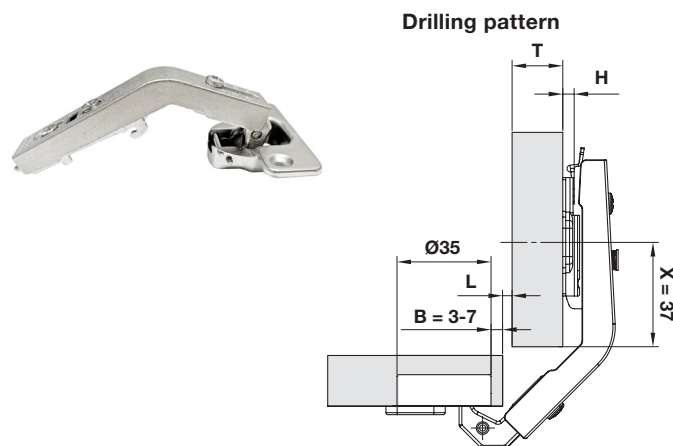

T	$T \leq 18$	$18 < T \leq 22$
H	2	0
X	37	37

Cup fixing	Version	Cat. No.
Drilling pattern 48/6		
Screw fixing	Without soft close	311.66.602
Knock-in		311.66.608

Packing: 50 pieces

METALLA 310 SM 90° HINGES



90° BLIND PANEL HINGES

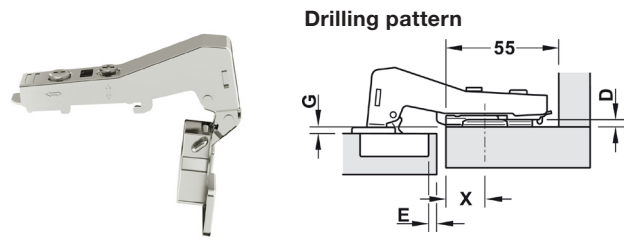

Door overlay G (mm)

X Dimension	Distance to cup	Mounting plate height (mm)		
		0	2	4
20	4	2.8	0.8	-1.2
19	5	2.8	0.8	-1.2

Cup fixing	Version	Cat. No.
Drilling pattern 48/6		
Screw fixing	With soft close	311.69.508
Screw fixing	Without soft close	311.69.502

Packing: 50 pieces

METALLA 310 SM 45° HINGES



45° CORNER HINGES

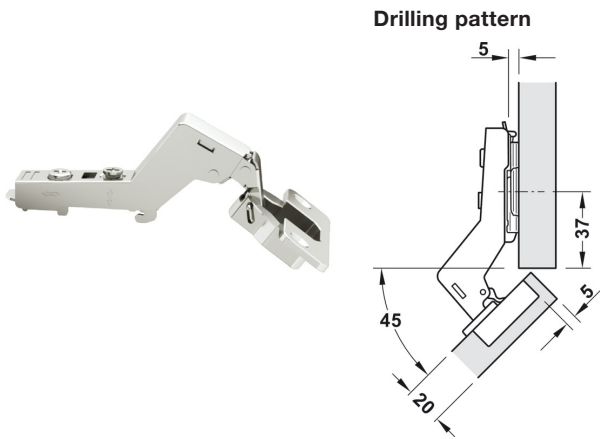

Cup fixing	Version	Cat. No.
Drilling pattern 48/6		
Screw fixing	With soft close	311.04.107
	Without soft close	311.69.404

Packing: 50 pieces

MOUNTING PLATES

METALLA 310 SM ECCENTRIC ADJUSTMENT

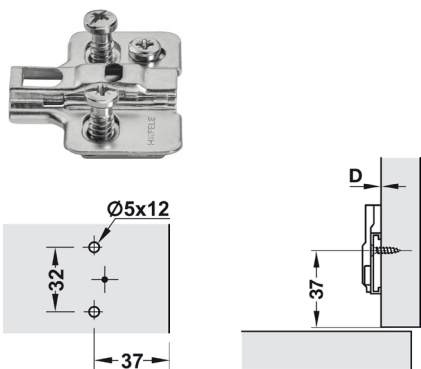

> Fixing:	With euro screw
-----------	-----------------

Height (mm)	Cat. No.
0	311.70.620
2	311.70.622
4	311.70.624

Packing: 250 pieces

MOUNTING PLATES

METALLA 310 SM CRUCIFORM MOUNTS

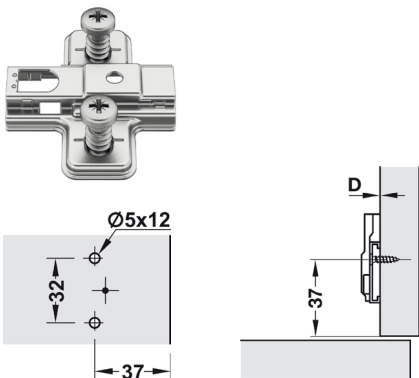

> Fixing:	With euro screw
-----------	-----------------

Height (mm)	Cat. No.
0	311.71.510
2	311.71.512
4	311.71.514

Packing: 250 pieces

HÄFELE FREE SPACE 1.11 / 6.15

PRODUCT RANGE OVERVIEW



Modern, compact design

Minimal installation depth from 63 mm and installation height from 172 mm do noticeably leave more usable storage space in the cabinet.

Compactible drill pattern

The plug-in pins on the base plate suit 1:1 the 32/37 mm line boring dimensions on the side wall and allow for a pre-installation of the fitting with just one hand.



Self-explanatory adjustments

Intuitive and comfortable tension adjustment from the front. 3D flap alignment with generous adjustment ranges. Integrated opening angle limiter 107° to 90°.

Mature Häfele flap technology

Free space expands the proven Free product family. Basic functions as adjustability of the tension force, integrated soft-close or 'push-to-open' are just a given as are high reliability and quality from the Häfele plant.



Fastest installation

Coming equipped with just one pre-set fixing screw, Free space can be fitted in record time.

Optimized logistics and processing

Less components are reducing transport and storage volume. At the same time installation becomes less complex and more time-efficient.

FREE SPACE DRILLING JIG

Side panel

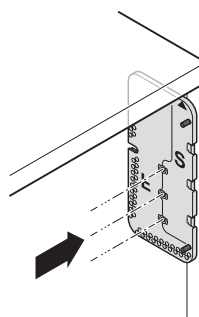

Front panel

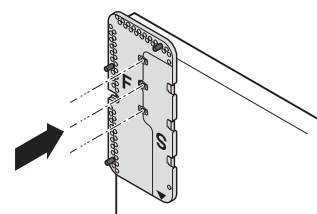

Cat. No.
372.27.602

DIMENSIONAL DRAWINGS

Front panel thickness Y (mm)	16	18	19	22	24	26	28
Distance X (mm) (with cabinet top panel thickness 16 mm)	117	110	107	96	90	83	76

Free Space 1.11

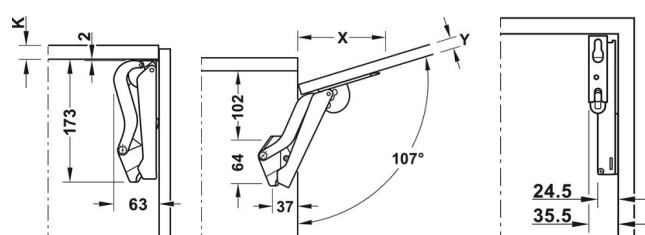

Free Space 6.15

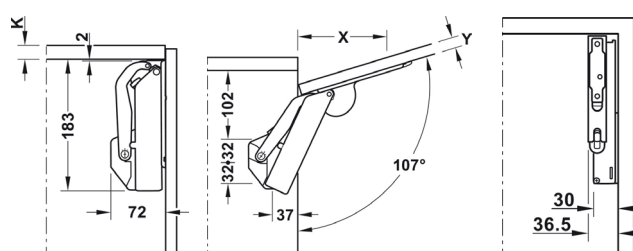

FREE SPACE STANDARD - WITH SOFT CLOSE

Free Space 1.11

Free Space 6.15



- > Area of application: For standard stay flap applications with front height up to 650 mm
- > Material: Housing: Plastic, front fixing bracket and support lever: Steel
- > Finish/colour: Front fixing bracket and support lever: Nickel plated, housing: White
- > Opening angle: 90° or 107°
- > Adjustment facility: Height, side, tilting angle, holding power
- > Installation: Fitting for screw fixing with pre-mounted Euro screws, front panel without tools, for sliding onto pre-mounted fixing screws

Model	B	C	D	E	F	G	H
Cabinet height (mm)	Flap weight (kg)						
225	2.3-4.3	3.8-7.1	6.4-9.3	9.2-13.4	13.4-19.1	-	-
250	1.9-3.9	3.4-6.4	5.8-9.1	8.3-12.6	21.1-17.2	-	-
275	1.9-3.5	3.1-5.8	5.3-8.2	7.5-12.0	11.0-15.6	-	-
300	1.7-3.2	2.8-5.3	4.8-7.5	6.9-11.0	10.1-14.3	-	-
325	1.6-3.0	2.6-4.9	4.4-7.0	6.4-10.2	9.3-13.2	-	-
350	1.5-2.8	2.4-4.6	4.1-6.5	5.9-9.5	8.6-12.3	11.7-18.9	18.0-25.7
375	1.3-2.6	2.2-4.3	3.8-6.0	5.5-8.8	8.1-11.4	10.9-17.6	16.8-24.0
400	1.2-2.4	2.1-4.0	3.6-5.6	5.2-8.3	7.6-10.7	10.2-16.5	15.8-22.5
425	1.1-2.3	2.0-3.8	3.4-5.3	4.9-7.8	7.1-10.1	9.6-15.5	14.8-21.2
450	1.0-2.1	1.9-3.5	3.2-5.0	4.6-7.3	6.7-9.5	9.1-14.7	14.0-20.0
475	1.0-2.0	1.8-3.4	3.0-4.7	4.3-7.0	6.4-9.0	8.6-13.9	13.3-18.9
500	0.9-1.9	1.7-3.2	2.9-4.5	4.1-6.6	6.0-8.6	8.2-13.2	12.6-18.0
525	0.9-1.8	1.6-3.0	2.7-4.3	3.9-6.3	5.7-8.2	7.8-12.6	12.0-17.1
550	0.8-1.7	1.5-2.9	2.6-4.1	3.7-6.0	5.5-7.8	7.4-12.0	11.5-16.4
575	0.8-1.7	1.4-2.8	2.5-3.9	3.6-5.7	5.2-7.4	7.1-11.5	11.0-15.7
600	0.8-1.6	1.4-2.7	2.4-3.7	3.4-5.5	5.0-7.1	6.8-11.0	10.5-15.0
625	0.7-1.5	1.3-2.5	2.3-3.6	3.3-5.3	4.8-6.8	6.5-10.6	10.1-14.4
650	0.7-1.5	1.3-2.4	2.2-3.5	3.2-5.1	4.6-6.6	6.3-10.2	9.7-13.8

Model	Cat. No.
Free Space 1.11	
B	372.27.700
C	372.27.701
D	372.27.702
E	372.27.703
F	372.27.704
Free Space 6.15	
G	372.27.721
H	372.27.722

Packing: 1 or 25 set

**Supplied with:**

- > 1 stay flap fitting set (1 piece each left/right)
- > 4 fixing screws for front panel
- > 1 set of installation instructions with paper drilling template for side panel

**Order Reference:**

The choice of the flap stay fitting for front panels with handles depends on the cabinet height and flap weight including handle. Model selection see sample measurements table.

FREE SPACE STANDARD - PUSH, WITHOUT A HANDLE

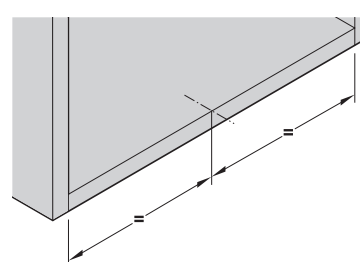
Free Space 1.8
Free Space 5.15
Positioning with 1 door catch

- > Area of application: For standard stay flap applications with front height up to 650 mm
- > Material: Housing: Plastic, front fixing bracket and support lever: Steel
- > Finish/colour: Front fixing bracket and support lever: Nickel plated, housing: White
- > Opening angle: 90° or 107°
- > Adjustment facility: Height, side, tilting angle, holding power, release distance on push catch
- > Installation: Fitting for screw fixing with pre-mounted Euro screws, front panel without tools, for sliding onto pre-mounted fixing screws

Model	B pto	C pto	D pto	E pto	F pto	G pto	H pto
Cabinet height (mm)	Flap weight (kg)						
225	2.3-4.3	3.8-7.1	6.4-9.3	9.2-13.4	-	-	-
250	1.9-3.9	3.4-6.4	5.8-9.1	8.3-12.6	-	-	-
275	1.9-3.5	3.1-5.8	5.3-8.2	7.5-12.0	-	-	-
300	1.7-3.2	2.8-5.3	4.8-7.5	6.9-11.0	-	-	-
325	1.6-3.0	2.6-4.9	4.4-7.0	6.4-10.2	-	-	-
350	1.5-2.8	2.4-4.6	4.1-6.5	5.9-9.5	8.7-12.3	11.7-18.9	18.0-25.7
375	1.3-2.6	2.2-4.3	3.8-6.0	5.5-8.8	8.1-11.5	10.9-17.6	16.8-24.0
400	1.2-2.4	2.1-4.0	3.6-5.6	5.2-8.3	7.6-10.8	10.2-16.5	15.8-22.5
425	1.1-2.3	2.0-3.8	3.4-5.3	4.9-7.8	7.2-10.1	9.6-15.5	14.8-21.2
450	1.0-2.1	1.9-3.5	3.2-5.0	4.6-7.3	6.8-9.6	9.1-14.7	14.0-20.0
475	1.0-2.0	1.8-3.4	3.0-4.7	4.3-7.0	6.4-9.1	8.6-13.9	13.3-18.9
500	0.9-1.9	1.7-3.2	2.9-4.5	4.1-6.6	6.1-8.6	8.2-13.2	12.6-18.0
525	0.9-1.8	1.6-3.0	2.7-4.3	3.9-6.3	5.8-8.2	7.8-12.6	12.0-17.1
550	0.8-1.7	1.5-2.9	2.6-4.1	3.7-6.0	5.5-7.8	7.4-12.0	11.5-16.4
575	0.8-1.7	1.4-2.8	2.5-3.9	3.6-5.7	5.3-7.5	7.1-11.5	11.0-15.7
600	0.8-1.6	1.4-2.7	2.4-3.7	3.4-5.5	5.1-7.2	6.8-11.0	10.5-15.0
625	0.7-1.5	1.3-2.5	2.3-3.6	3.3-5.3	4.9-6.9	6.5-10.6	10.1-14.4
650	0.7-1.5	1.3-2.4	2.2-3.5	3.2-5.1	4.7-6.6	6.3-10.2	9.7-13.8

Model	Cat. No.
Free Space 1.8	
B pto	372.27.705
C pto	372.27.706
D pto	372.27.707
E pto	372.27.708
Free Space 5.15	
F pto	372.27.730
G pto	372.27.731
H pto	372.27.732

Packing: 1 or 25 set

Supplied with:

- > 1 stay flap fitting set (1 piece each left/right)
- > 4 fixing screws for front panel
- > 1 Free push catch
- > 1 set of installation instructions with paper drilling template for side panel

Order Reference:

The choice of the flap stay fitting for front panels with handles depends on the cabinet height and flap weight including handle. Model selection see sample measurements table.



MATRIX DRAWER SYSTEM 09.2023
732.98.460

Häfele New Zealand Ltd.

Auckland Head Office 16 Accent Drive, East Tamaki

Auckland Home Ideas Centre 165 The Strand, Parnell

Wellington Design Centre The Wool Store, Level 1 262 Thorndon Quay

Christchurch Design Centre 12 Sir James Wattie Drive, Hornby

0800 442 335 | sales@hafele.co.nz | www.hafele.co.nz